



MINI DEKKER LZR

User Manual

Rev. 04/22/2024

Startec
SERIES
by ADJ

©2024 **ADJ Products, LLC** all rights reserved. Information, specifications, diagrams, images, and instructions herein are subject to change without notice. ADJ Products, LLC logo and identifying product names and numbers herein are trademarks of ADJ Products, LLC. Copyright protection claimed includes all forms and matters of copyrightable materials and information now allowed by statutory or judicial law or hereinafter granted. Product names used in this document may be trademarks or registered trademarks of their respective companies and are hereby acknowledged. All non-ADJ Products, LLC brands and product names are trademarks or registered trademarks of their respective companies.

ADJ Products, LLC and all affiliated companies hereby disclaim any and all liabilities for property, equipment, building, and electrical damages, injuries to any persons, and direct or indirect economic loss associated with the use or reliance of any information contained within this document, and/or as a result of the improper, unsafe, insufficient and negligent assembly, installation, rigging, and operation of this product.

Europe Energy Saving Notice

Energy Saving Matters (EuP 2009/125/EC)

Saving electric energy is a key to help protecting the environment. Please turn off all electrical products when they are not in use. To avoid power consumption in idle mode, disconnect all electrical equipment from power when not in use. Thank you!

CONTENTS

Introduction	4
General Instructions Features Warranty Registration	5
Safety Precautions	6
Laser Warning and Safety	7
DMX Set Up	9
Layout	11
Laser Warning Labels	12
System Menu	13
Operation Instructions Primary-Secondary Set Up	17
UC IR Control	18
CAD Drawing	19
DMX Traits	20
Fuse Replacement Trouble Shooting Cleaning	22
Warranty	23
Specifications	24

INTRODUCTION

Unpacking: Thank you for purchasing the Mini Dekker LZR by ADJ Products, LLC. Every Mini Dekker LZR has been thoroughly tested and has been shipped in perfect operating condition. Carefully check the shipping carton for damage that may have occurred during shipping. If the carton appears to be damaged, carefully inspect your fixture for any damage and be sure all accessories necessary to operate the unit have arrived intact. In the event that damage is found or parts are missing, please contact our toll free customer support number for further instructions. Do not return this unit to your dealer without first contacting customer support.

Introduction: The Mini Dekker LZR is part of ADJ's continuing pursuit for creating high quality affordable intelligent fixtures. The Mini Dekker LZR is a DMX intelligent LED moonflower effect with laser. This fixture can be used in a stand alone mode or connected in a Primary/Secondary configuration. This fixture has three operating modes: Sound Active mode, Show mode, and DMX control.

Customer Support: ADJ Products, LLC provides a toll free customer support line, to provide set up help and to answer any questions should you encounter problems during your set up or initial operation. You may also visit us on the web at www.adj.com for any comments or suggestions. Service Hours are Monday through Friday 8:00 a.m. to 4:30 p.m. Pacific Standard Time.

Voice: (323) 582-2650
E-mail: support@adj.com

To purchase parts online visit parts.adj.com.

Warning! To prevent or reduce the risk of electrical shock or fire, do not expose this unit to rain or moisture.

Caution! There are no user serviceable parts inside this unit. Do not attempt any repairs yourself, doing so will void your manufacturer's warranty. In the unlikely event your unit may require service please contact ADJ Products, LLC.

PLEASE recycle the shipping carton when ever possible.

GENERAL INSTRUCTIONS

To optimize the performance of this product, please read these operating instructions carefully to familiarize yourself with the basic operations of this unit. These instructions contain important safety information regarding the use and maintenance of this unit. Please keep this manual with the unit for future reference.

FEATURES

- Includes Hanging Yoke
- 3 Operating Modes: Show Mode, Sound Active, & DMX Control
- Light Weight
- Strobing
- Electronic Dimming 0-100%
- Built in Microphone
- DMX-512 protocol
- 2 DMX Channel Modes: 2 Channels & 7 Channels

WARRANTY REGISTRATION

The Mini Dekker LZR carries a 1 Year limited warranty. Please fill out the enclosed warranty card to validate your purchase. All returned service items whether under warranty or not, must be freight pre-paid and accompany a return authorization (R.A.) number. The R.A. number must be clearly written on the outside of the return package. A brief description of the problem as well as the R.A. number must also be written down on a piece of paper and included in the shipping container. If the unit is under warranty, you must provide a copy of your proof of purchase invoice. You may obtain an R.A. number by contacting customer support at (800) 322-6337.

SAFETY PRECAUTIONS



Safety Issue: This unit may “pop” the fuse if the maximum allotted load of 2 amps is reached.

- To reduce the risk of electrical shock or fire, do not expose this unit to rain or moisture.
- Do not spill water or other liquids into or on to your unit.
- Do not attempt to remove or break off the ground prong from the electrical cord. This prong is used to reduce the risk of electrical shock and fire in case of an internal short.
- Do not attempt to operate this unit if the power cord is frayed or broken.
- Disconnect from main power before making any type of connection.
- Do not remove the cover for any reason. There are no user serviceable parts inside.
- Always be sure to mount this unit in an area that will allow proper ventilation. Allow about 6” (15cm) between this device and a wall.
- Do not attempt to operate this unit if it has been damaged in any way.
- This unit is intended for indoor use only. Use of this product outdoors voids all warranties.
- During long periods of non-use, disconnect the unit’s main power.
- Always mount this unit in safe and stable matter.
- Power cords should be routed so they are not likely to be walked on or pinched by items placed upon or against them.
- Cleaning - The fixture should be cleaned only as recommended by the manufacturer. See the **Cleaning** section of this manual for details.
- Heat - The appliance should be situated away from heat sources such as radiators, heat registers, stoves, or other appliances (including amplifiers) that produce heat.
- The fixture should be serviced by qualified service personnel when:
 - A. The power-supply cord or the plug has been damaged.
 - B. Objects have fallen onto, or liquid has been spilled into, the unit.
 - C. The unit has been exposed to rain or water.
 - D. The unit does not appear to operate normally or exhibits a marked change in performance.

LASER WARNINGS AND SAFETY

NON-INTERLOCKED HOUSING WARNING

The Mini Dekker LZR contains internal high-powered laser devices. Do not open the laser housing, as doing so may result in potential exposure to unsafe levels of laser radiation. If the unit is operated while open, the laser device can cause instant blindness, skin burns, and fires.

CAREFULLY READ ALL LASER SAFETY DATA, OPERATION INSTRUCTIONS, AND LASER SAFETY BEFORE OPERATING THIS DEVICE!

The light source emitted from this product can potentially cause eye injury if not set up and used properly. The light source emitted from a laser is very different from any other light sources that may be encountered in entertainment lighting. Laser light is thousands of times more concentrated than light from any other kind of light source. This concentration of light can cause instant eye injuries, primarily by burning the retina (the back of your eyeball containing cells that are sensitive to light). Even if you cannot feel “heat” from a laser beam, it can still potentially injure or blind you or your audience. Even very small amounts of laser beam light are potentially hazardous even at long distances. Laser eye injuries can be sustained faster than you can blink.

Do not assume that because this laser splits the laser beam into hundreds of beams and that the laser beam is scanned out in high speed, that an individual laser beam is safe for eye exposure. This laser uses dozens of milliwatts of laser power (Class 3B levels internally) before it splits into multiple beams (Class 3R levels). Many of the individual beams are potentially hazardous to the eyes.

Do not assume that because the laser light is moving, it is safe. This is not true. Nor do the laser beams always move. Since eye injuries can occur instantly, it is critical to prevent even the smallest possibility of any direct eye exposure. According to laser safety regulations, it is illegal to aim Class 3R lasers in areas where there is high potential for exposure. This is true even if it is aimed below people’s faces, such as on a dance floor.

Do not operate the laser without first reading and understanding all safety and technical data in this manual.

Always set up and install all laser effects so that all laser light is at least 3 meters (9.8 feet) above the floor on which people can stand.

LASER WARNINGS AND SAFETY

After setting up this device, and before public use, carry out a test to ensure proper function. Do not use if any defects are detected. Do not use if the device emits only one or two laser beams rather than dozens/hundreds, as this could indicate damage to the diffraction grating optic, and could allow emission of higher laser levels above Class 3R.

- Do not point lasers at people or animals. Never look into the laser aperture or laser beams.
- Do not point lasers in areas where people can potentially get exposed, such as uncontrolled balconies, etc.
- Do not point lasers at highly reflective surfaces, such as windows, mirrors, and shiny metal. Even laser reflections can be hazardous.
- Never point a laser at aircraft. This is a federal offense.
- Never point un-terminated laser beams into the sky.
- Do not expose the output optic (aperture) to cleaning chemicals.
- Do not use laser if the laser appears to be emitting only one or two beams.
- Do not use the laser if the housing is damaged, if the housing is open, or if the optics appear damaged in any way.
- Never open the laser housing. The high laser power levels inside of the protective housing can start fires, burn skin, or cause instant eye injury.
- Never leave this device running unattended.
- The operation of a class 3R laser show is only allowed if the show is controlled by a skilled and well-trained operator who is familiar with the data included in this manual.
- The legal requirements for using laser entertainment products vary from country to country. The user is responsible for the legal requirements at the location/country of use.
- Always use proper lighting safety cables when hanging lights and effects overhead.

DMX SET UP

Power Supply: The ADJ Mini Dekker LZR contains an automatic voltage switch, which will automatically sense the voltage when it is plugged into the power source. With this switch there is no need to worry about the correct power voltage, and this unit can be plugged in anywhere.

DMX-512: DMX is short for Digital Multiplex. This is a universal protocol used as a form of communication between intelligent fixtures and controllers. A DMX controller sends DMX data instructions from the controller to the fixture. DMX data is sent as serial data that travels from fixture to fixture via the DATA “IN” and DATA “OUT” XLR terminals located on all DMX fixtures (most controllers only have a DATA “OUT” terminal).

DMX Linking: DMX is a language allowing all makes and models of different manufacturers to be linked together and operate from a single controller, as long as all fixtures and the controller are DMX compliant. When using several DMX fixtures, try to use the shortest cable path possible in order to ensure proper DMX data transmission. The order in which fixtures are connected in a DMX line does not influence the DMX addressing. For example, a fixture assigned a DMX address of 1 may be placed anywhere in a DMX line: at the beginning, at the end, or anywhere in the middle. When a fixture is assigned a DMX address of 1, the DMX controller knows to send DATA assigned to address 1 to that unit, no matter where it is located in the DMX chain.

Data Cable (DMX Cable) Requirements (For DMX Operation): The Mini Dekker LZR has two DMX channel modes: a 2 channel mode and 7 channel mode. The DMX address is set electronically using the controls on the rear panel of the unit. Your unit and your DMX controller require an approved DMX-512 110 Ohm Data cable for data input and data output. We recommend Accu-Cable DMX cables. If you are making your own cables, be sure to use standard 110-120 Ohm shielded cable (This cable may be purchased at almost all professional sound and lighting stores). Your cables should be made with a male and female XLR connector on either end of the cable. Also remember that DMX cable must be daisy chained and cannot be split.



Figure 1

DMX SET UP

Notice: Be sure to follow figures two and three when making your own cables. Do not use the ground lug on the XLR connector. Do not connect the cable's shield conductor to the ground lug or allow the shield conductor to come in contact with the XLR cable's outer casing. Grounding the shield could cause a short circuit and erratic behavior.

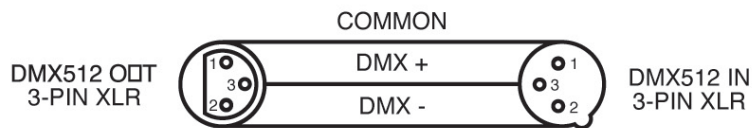

Figure 2

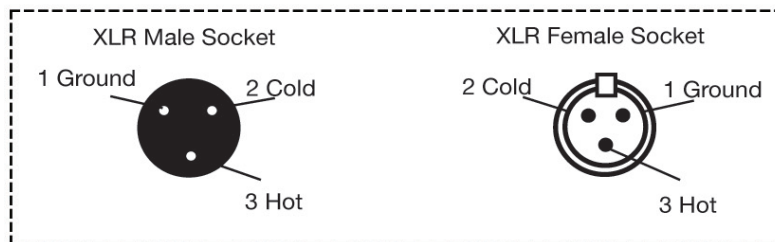
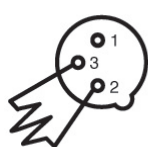

Figure 3

XLR Pin Configuration	
Pin 1 =	Ground
Pin 2 =	Data Compliment (negative)
Pin 3 =	Data True (positive)

Special Note: Line Termination. When longer runs of cable are used, you may need to use a terminator on the last unit to avoid erratic behavior. A terminator is a 110-120 ohm 1/4 watt resistor which is connected between pins 2 and 3 of a male XLR connector (DATA+ and DATA-). This unit is inserted in the female XLR connector of the last unit in your daisy chain to terminate the line. Using a cable terminator (ADJ part number **Z-DMX/T**) will decrease the chances of erratic behavior.



Termination reduces signal errors and avoids signal transmission problems and interference. It is always advisable to connect a DMX terminal, (Resistance 120 Ohm 1/4 W) between PIN 2 (DMX-) and PIN 3 (DMX +) of the last fixture.

Figure 4

5-Pin XLR DMX Connectors. Some manufacturers use 5-pin DMX-512 data cables for DATA transmission in place of 3-pin. 5-pin DMX fixtures may be implemented in a 3-pin DMX line. When inserting standard 5-pin data cables in to a 3-pin line a cable adaptor must be used. These adaptors are readily available at most electronics stores. The chart below details a proper cable conversion.

3-Pin XLR to 5-Pin XLR Conversion		
Conductor	3-Pin XLR Female (Out)	5-Pin XLR Male (In)
Ground/Shield	Pin 1	Pin 1
Data Compliment (- signal)	Pin 2	Pin 2
Data True (+ signal)	Pin 3	Pin 3
Not Used		Do Not Use
Not Used		Do Not Use

LAYOUT

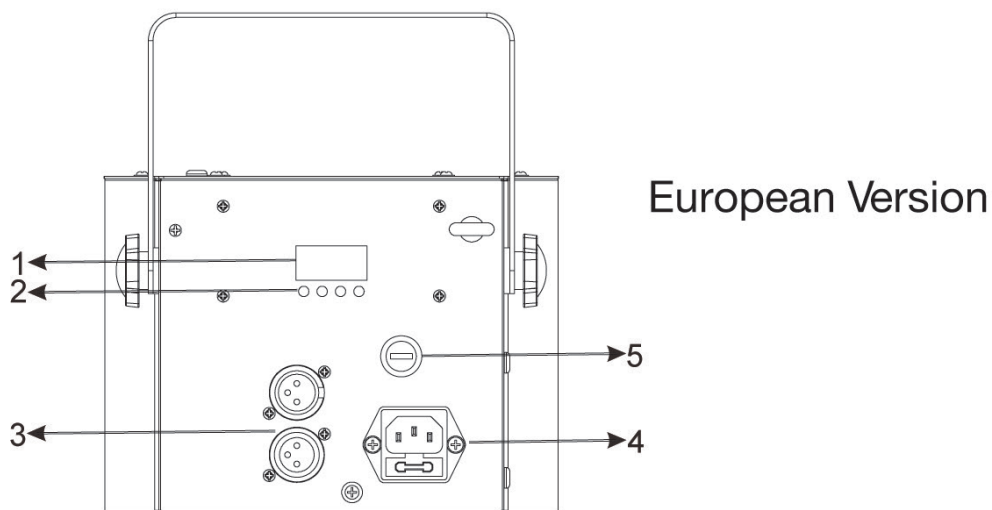
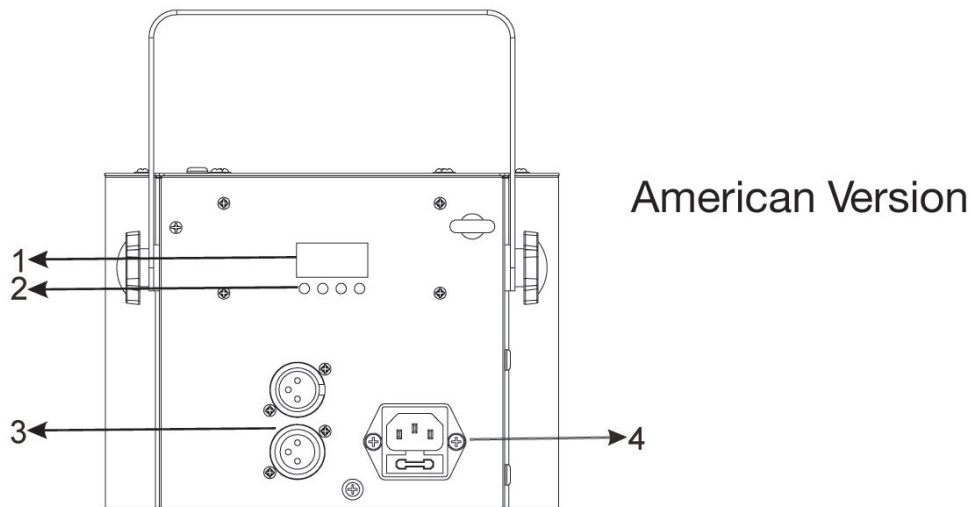

1. Function Display: Used to show the various menus and selected functions.

2. Buttons:

MENU	Select programming functions
UP	Go backward in the menu of functions
DOWN	Go forward in the menu of functions
ENTER	Confirm selection

3. DMX In/Out: Used to link multiple units together via 3-pin XLR cables.

4. Power In: Used to connect to the power supply.

5. Laser Switch: Used to turn the laser on or off. (EU version only)

LASER WARNING LABELS

American Version

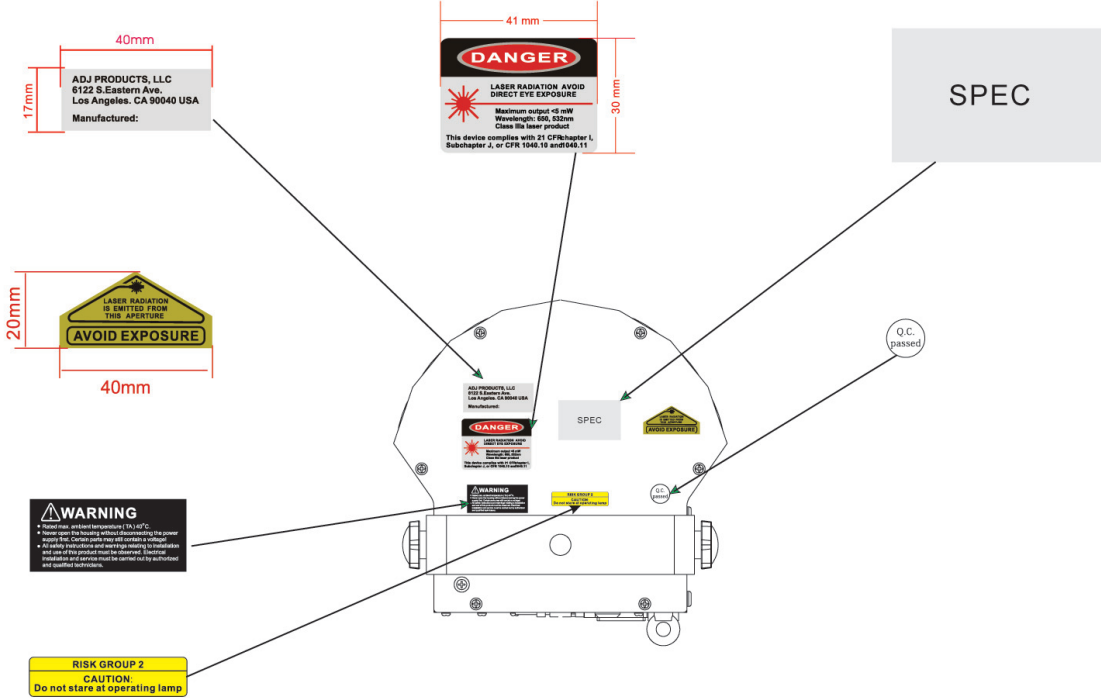

Europe Version

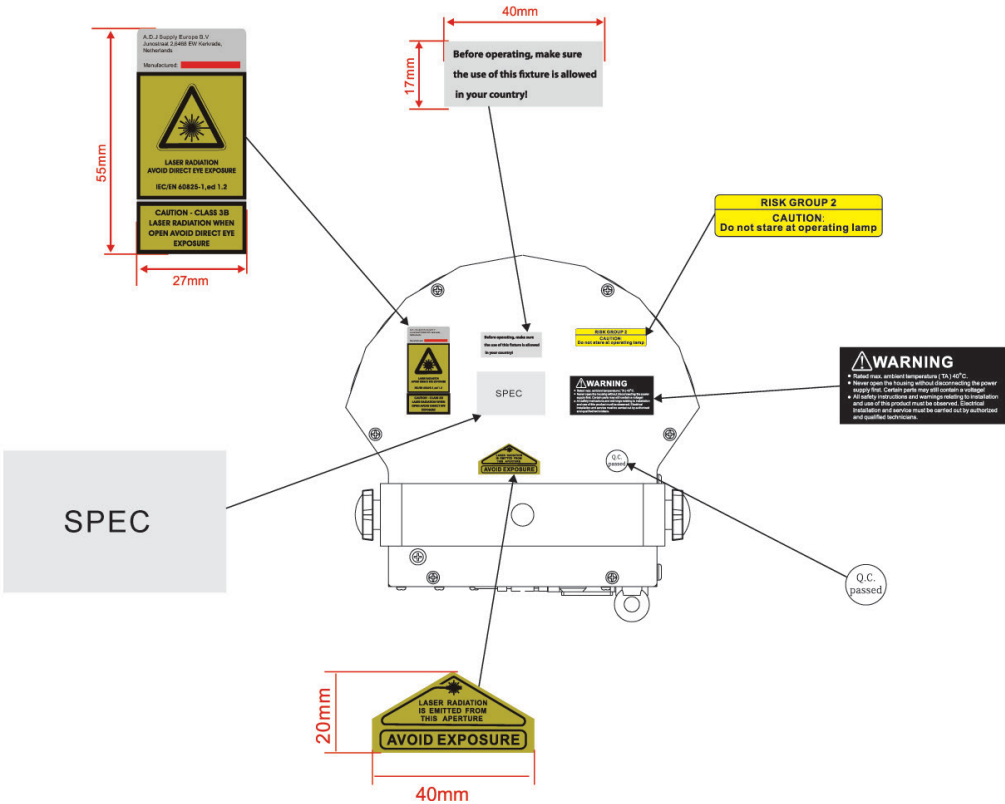

SYSTEM MENU

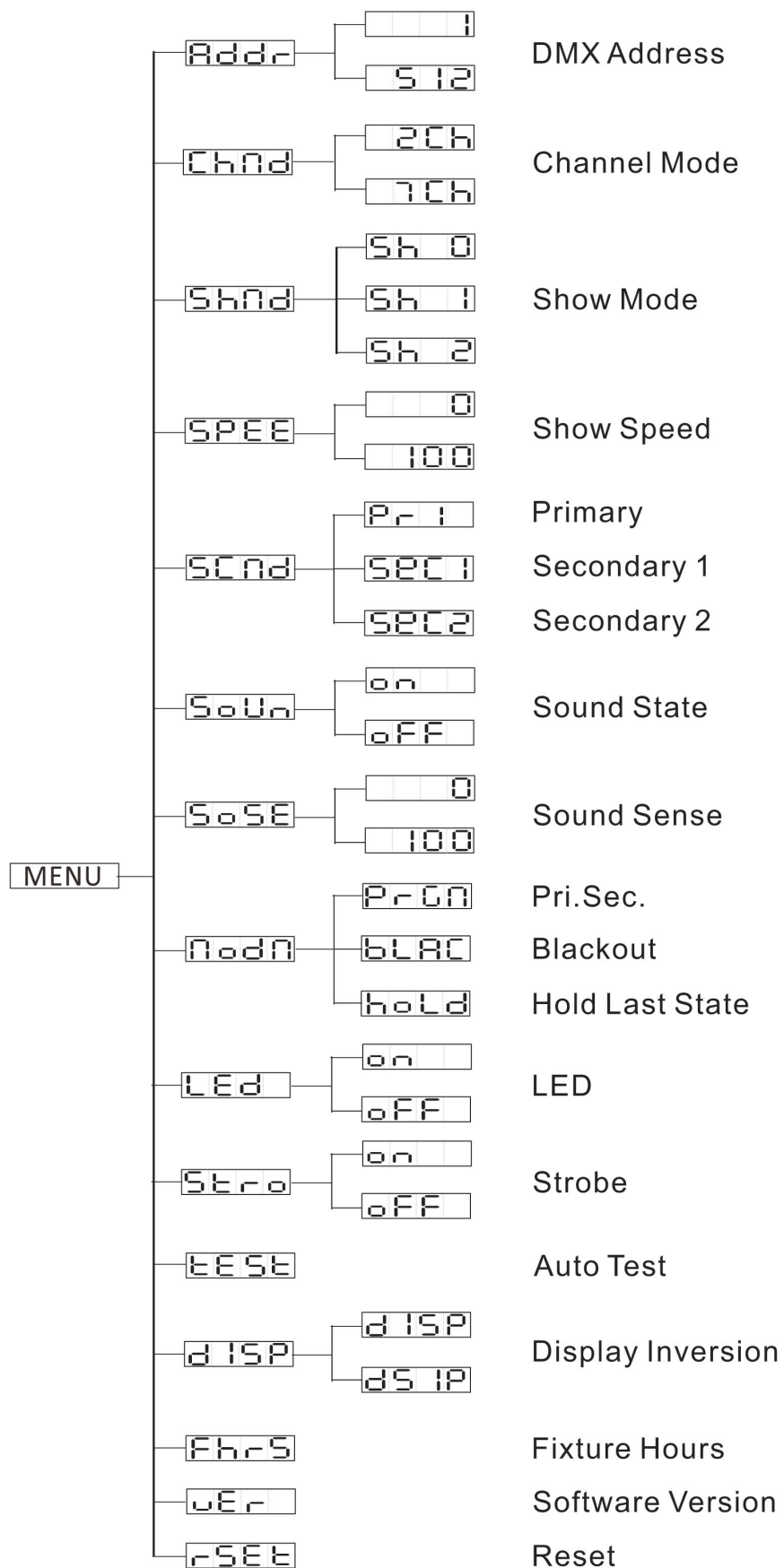

SYSTEM MENU

System Menu: When making adjustments, press *ENTER* to confirm your setup, then press and hold the *MENU* button for at least 3 seconds. To exit without making any adjustments press the *MENU* button. The display will lock after 30 seconds. Press the *MENU* button for 3 seconds to unlock.

ADDR - DMX Address Setting.

1. Press the either the *MENU*, *UP*, or *DOWN* buttons until “ADDR” is displayed. Press *ENTER*.
2. The current address will now be displayed and flashing. Press the *UP* or *DOWN* buttons to find your desired address. Press *ENTER* to set your desired DMX address.

CHND - This will let select your desired DMX channel mode.

1. Press the *MENU* button until “CHND” is displayed, and press *ENTER*. The current DMX channel mode will be displayed.
2. Press the *UP* or *DOWN* buttons to find your desired DMX channel mode and press *ENTER* to confirm and exit.

SHND - Show modes 0-2 (Factory programs).

1. Press the *MENU* button until “SHND” is displayed, and press *ENTER*.
2. “Sh X” will now be displayed, “X” representing a number between 0-2. Shows 1-2 are factory programs, while show “0” is random mode. Use the *UP* or *DOWN* buttons to find your desired show.
3. When you have found your desired show press *ENTER*, then press and hold the *MENU* button for at least 3 seconds to activate. After you have set your desired show, it can be changed at any time using the *UP* or *DOWN* buttons.

SPEE - Show mode speed.

1. Press the *MENU* button until “SPEE” is displayed, and press *ENTER*.
2. A number between 0-100 will now be displayed, representing the current speed setting. Use the *UP* or *DOWN* buttons to adjust the show speed. “0” is the slowest speed and “100” is the fastest.
3. Press *ENTER* to set the speed then press and hold the *MENU* button for at least 3 seconds to exit.

SCND - This will let you set unit as a primary or secondary in a primary/secondary configuration.

1. Press the *MENU* button until “SCND” is displayed, and press *ENTER*. Either “PRI”, “SEC1”, or “SEC2” will be displayed.
2. Press the *UP* or *DOWN* buttons until your desired setting is displayed, and press *ENTER* to confirm.

NOTE: In a Primary/Secondary configuration, if one fixture is set to Primary and the next is set to “SEC 2”, the fixtures will now have contrasting movements.

SOUN - Sound Active mode.

1. Press the *MENU* button until “SOUN” is displayed, and press *ENTER*.
2. The display will show either “ON” or “OFF”. Press the *UP* or *DOWN* buttons to select “ON” to activate sound active mode, or “OFF” to deactivate sound active mode.
3. Press *ENTER* to confirm.

SYSTEM MENU

SOSE - In this mode you can adjust the sound sensitivity.

1. Press the MENU button until "SOSE" is displayed, and press ENTER.
2. A number between 0-100 will be displayed. Press the UP or DOWN buttons to adjust the sound sensitivity. 0 is the least sensitive, and 100 is the most sensitive.
3. When you have found your desired setting press ENTER to confirm.

NODN - This setting defines the behavior of the fixture in the event that the DMX signal is lost or interrupted. It also determines the operating mode that the fixture defaults to when it is first powered up following a shut down.

1. Press the MENU button until "NODN" is displayed, and either "PRGN", "BLAC", or "HOLD" will be displayed beneath.
2. Press ENTER and the bottom choice will begin to flash. Use the UP or DOWN buttons to choose an operating mode you would like the unit to start up in when power is applied or the DMX signal is lost.
 - HOLD - If the DMX signal is lost the fixture will stay in the last DMX setting. If power is applied and this mode is set, the unit will automatically go into the last DMX set up.
 - PRGN (Primary Secondary) - If the DMX signal is lost or power is applied, the unit will automatically go into Primary Secondary mode and run a built-in show.
 - BLAC (Blackout) - If the DMX signal is lost or interrupted, the unit will automatically go into stand by mode.
3. Press ENTER to confirm your desired set up.

LED - With this function you can set the LED display to turn off after 10 seconds of inactivity.

1. Press the MENU button until "LED" is displayed, and press ENTER.
2. The display will show either "ON" or "OFF". Press the UP or DOWN buttons to select "ON" to keep the LED display on at all times, or "OFF" to switch to have the LED display switch off after 10 seconds.

STRO - This will activate strobing.

1. Press the MENU button until "STRO" is displayed, and press ENTER.
2. Use the UP or DOWN buttons to activate or deactivate strobing.

TEST - This function will run a self test program.

1. Press the MENU button until "TEST" is displayed, and press ENTER.
2. The fixture will now run a self test.

DISP - This function will reverse the display 180°.

1. Press the MENU button until "DISP" is displayed, and press ENTER.
2. To invert the display, press the UP or DOWN buttons. "DISP" shows the display in standard orientation, while "DSIP" inverts the display.
3. Press ENTER to confirm. To make you LED display reappear again press any button.

SYSTEM MENU

FHRS - With this function you can display the run time of the unit.

1. Press the MENU button until “FHRS” is displayed, and press ENTER.
2. The run time of the fixture will now be displayed. Press MENU to exit.

VER - Use this function to display the Software version of the unit.

1. Press the either the MENU button until “VER” is displayed, and press ENTER.
2. The display will show the software version.

RSET - This function will reset the unit.

1. Press the MENU button until “RSET” is displayed.
2. Press the ENTER button and the unit will reset itself.

OPERATING INSTRUCTIONS

Universal DMX Control: This function allows you to use a universal DMX-512 controller to control the patterns, rotation and strobing. A DMX controller allows you to create unique programs tailored to your individual needs.

1. The Mini Dekker LZR has two DMX channel modes: a 2 channel mode and a 7 channel mode.
See the **DMX Mode** sections of this manual for detailed description of the DMX values and traits.
2. To control your fixture in DMX mode, follow the set-up procedures in the **DMX Set Up** section of this manual, as well as the set-up specifications that are included with your DMX controller.
3. Follow the instructions in the **System Menu** section of this manual to set the DMX address.
4. For longer cable runs (more than a 100 feet), use a terminator on the last fixture.
5. For help operating in DMX mode consult the manual included with your DMX controller.

Sound Active Mode: This mode allows a single unit or several units linked together, to run to the beat of the music.

1. Press the MENU button until “Soun” is displayed, and press ENTER.
2. Press the UP or DOWN buttons to either activate or deactivate sound active mode, and press ENTER. If activated, the unit will now run to the beat of the music.
3. The sound sensitivity can be adjusted by turning the sound sensitivity knob located on the back of the unit. Turn the knob clockwise for greater sensitivity and counter-clockwise for reduced sensitivity.

Show Mode: This mode allows a single unit or several units linked together to run to a built-in program.

1. Press the MENU button until “Show” is displayed.
2. Press ENTER to activate.

PRIMARY-SECONDARY SET UP

Primary-Secondary Operation: This function will allow you to link up to 16 units together and operate without a controller. In a Primary-Secondary set-up, one unit will act as the controlling unit and the others will react to the controlling unit’s programs. Any unit can act as a Primary or a Secondary.

1. Using standard XLR microphone cables, daisy chain your units together via the XLR connector on the rear of each unit. Remember that the male XLR connector is the input and the female XLR connector is the output. The first unit in the chain (primary) will use the female XLR connector only, and the last unit in the chain will use the male XLR connector only. For longer cable runs, the installation of a terminator at the last fixture is recommended.
2. Set the Primary unit to the desired operating mode.
3. Set the Secondary unit(s) to address “001”.
4. The Secondary unit(s) will now follow the Primary unit.

UC IR CONTROL

Note: The device must be set up in Primary Mode in order to allow control via UC IR. This capability is disabled when the device is in Secondary Mode. Please see the **Primary-Secondary Set Up** section of this manual for detailed information.

The **UC IR (sold separately)** infrared remote gives you control of various functions. To control the fixture you must aim the remote at the front of the fixture. Maximum range is 30 feet.

STAND BY - Press this button to black out the fixture. Press the button again to return to the initial state.

FULL ON - Hold this button down to fully illuminate the unit. When the button is released, the unit will return to its previous state.

STROBE - Press and hold this button for strobing.

FADE/GOBO - This button has no defined function for this device.

“DIMMER +” and “DIMMER -” - These buttons have no defined function for this fixture.

COLOR - Press this button to select a color. Use buttons 1-9 to find your desired color.

1-9 - Use buttons 1-9 to select your desired color when color mode is active. Use buttons 0-2 to select your desired show when in show mode.

SOUND ON & OFF - Use the buttons to activate and deactivate sound active mode.

SHOW 0 - Press this button to activate show mode and press this button again to activate random show (Show 0). Use buttons 1 & 2 to to run either show 1 or show 2.

CAD DRAWING

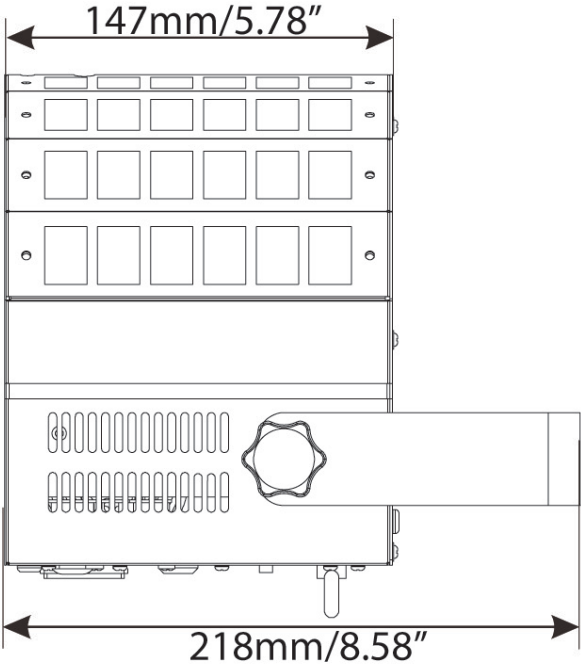
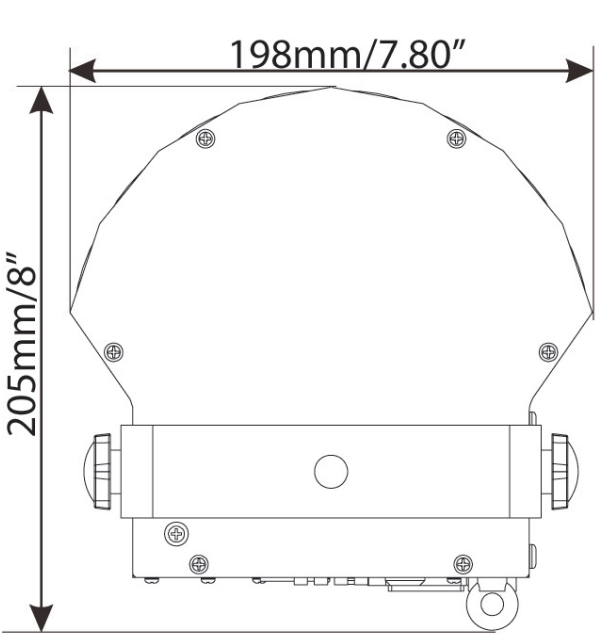

DMX TRAITS

CHANNEL		DMX VALUES	FUNCTIONS
2Ch	7Ch		
1	1		Show Mode
		0 - 9	No Function
		10 - 98	Show 0 (LED, Laser, & Strobe)
		90 - 169	Show 1 (LED)
		170 - 255	Show 2 (Laser)
2			Show Speed / Sound Sensitivity
		0 - 247	Show Speed, slow to fast
		248 - 255	Sound Active
	2		RGBW Color Macro
		0 - 9	No Function
		10 - 22	Red
		23 - 35	Green
		36 - 48	Blue
		49 - 61	White
		62 - 74	Red + Green
		75 - 87	Red + Blue
		88 - 100	Red + White
		101 - 113	Green + Blue
		114 - 126	Green + White
		127 - 139	Blue + White
		140 - 152	Red + Green + Blue
		153 - 165	Red + Green + White
		166 - 178	Green + Blue + White
		179 - 191	Green + Blue + White
		192 - 198	Red + Green + Blue + White
		199 - 225	Color Fade (1 Color), slow to fast
		226 - 255	Color Fade (Mixed), slow to fast

DMX TRAITS

CHANNEL		DMX VALUES	FUNCTION
2Ch	7Ch		
	3		<i>LED Strobe</i>
		0 - 9	Strobe Off
		10 - 244	Strobing, slow to fast
		245 - 255	Sound Active Strobe
	4		<i>Laser Color Control</i>
		0 - 9	Laser Off
		10 - 49	Red
		50 - 89	Green
		90 - 129	Red & Green
		130 - 169	Red On, Green Flash
		170 - 209	Green On, Red Flash
		210 - 249	Red & Green Flash
		250 - 255	Red & Green Alternate Flash
	5		<i>Laser Strobing</i>
		0 - 244	Strobing, slow to fast
		245 - 255	Sound Active Strobe
	6		<i>LED Motor Control</i>
		0 - 127	Select Motor Position
		128 - 255	Rotation, slow to fast
	7		<i>Laser Motor Control</i>
		0 - 127	Laser Patterns
		128 - 255	Pattern Chase, slow to fast

FUSE REPLACEMENT

Disconnect the unit from its power source. Remove the power cord from the unit. Once the cord has been removed, locate the fuse holder inside the power socket. Insert a flat-head screw driver into the power socket and gently pry out the fuse holder. Remove the bad fuse and replace with a new one. Note that the fuse holder also has a holder for a spare fuse.

TROUBLE SHOOTING

Listed below are a few common problems that you may encounter, with potential solutions.

No light output from the unit:

- Check that the fuse has not blown. The fuse is located on the rear panel.

The unit does not respond to sound:

- Low frequencies (bass) should cause the unit to react to sound. Quiet or high-pitched sounds, such as tapping on the microphone, may not activate the unit.

CLEANING

Due to fog residue, smoke, and dust, cleaning the internal and external optical lenses must be carried out periodically to optimize light output.

- Use normal glass cleaner and a soft cloth to wipe down the outside casing.
- Use a brush to wipe down the fan grill.
- Clean the external optics with glass cleaner and a soft cloth every 20 days.
- Clean the internal optics with glass cleaner and a soft cloth every 30-60 days.
- Always be sure to dry all parts completely before plugging the unit back in.

Cleaning frequency depends on the environment in which the fixture operates (i.e. smoke, fog residue, dust, dew). In heavy club use, cleaning on a monthly basis is recommended. Periodic cleaning will ensure longevity and crisp output.

WARRANTY

MANUFACTURER'S LIMITED WARRANTY

- A. ADJ Products, LLC hereby warrants, to the original purchaser, ADJ Products, LLC products to be free of manufacturing defects in material and workmanship for a prescribed period from the date of purchase (see specific warranty period on reverse). This warranty shall be valid only if the product is purchased within the United States of America, including possessions and territories. It is the owner's responsibility to establish the date and place of purchase by acceptable evidence, at the time service is sought.
- B. For warranty service you must obtain a Return Authorization number (RA#) before sending back the product—please contact ADJ Products, LLC Service Department at 800-322-6337. Send the product only to the ADJ Products, LLC factory. All shipping charges must be pre-paid. If the requested repairs or service (including parts replacement) are within the terms of this warranty, ADJ Products, LLC will pay return shipping charges only to a designated point within the United States. If the entire instrument is sent, it must be shipped in its original package. No accessories should be shipped with the product. If any accessories are shipped with the product, ADJ Products, LLC shall have no liability whatsoever for loss of or damage to any such accessories, nor for the safe return thereof.
- C. This warranty is void if the serial number has been altered or removed; if the product is modified in any manner which ADJ Products, LLC concludes, after inspection, affects the reliability of the product; if the product has been repaired or serviced by anyone other than the ADJ Products, LLC factory unless prior written authorization was issued to purchaser by ADJ Products, LLC; if the product is damaged because not properly maintained as set forth in the instruction manual.
- D. This is not a service contract, and this warranty does not include maintenance, cleaning or periodic check up. During the period specified above, ADJ Products, LLC will replace defective parts at its expense with new or refurbished parts, and will absorb all expenses for warranty service and repair labor by reason of defects in material or workmanship. The sole responsibility of ADJ Products, LLC under this warranty shall be limited to the repair of the product, or replacement thereof, including parts, at the sole discretion of ADJ Products, LLC. All products covered by this warranty were manufactured after August 15, 2012, and bear identifying marks to that effect.
- E. ADJ Products, LLC reserves the right to make changes in design and/or improvements upon its products without any obligation to include these changes in any products theretofore manufactured.

No warranty, whether expressed or implied, is given or made with respect to any accessory supplied with products described above. Except to the extent prohibited by applicable law, all implied warranties made by ADJ Products, LLC in connection with this product, including warranties of merchantability or fitness, are limited in duration to the warranty period set forth above. And no warranties, whether expressed or implied, including warranties of merchantability or fitness, shall apply to this product after said period has expired. The consumer's and/or Dealer's sole remedy shall be such repair or replacement as is expressly provided above; and under no circumstances shall ADJ Products, LLC be liable for any loss or damage, direct or consequential, arising out of the use of, or inability to use, this product.

This warranty is the only written warranty applicable to ADJ Products, LLC Products and supersedes all prior warranties and written descriptions of warranty terms and conditions heretofore published.

MANUFACTURER'S LIMITED WARRANTY PERIODS:

- **Lighting Products = 1-year (365 days) Limited Warranty** (Such as: Special Effect Lighting, Intelligent Lighting, UV lighting, Strobos, Fog Machines, Bubble Machines, Mirror Balls, Par Cans, Trussing, Lighting Stands etc. excluding LED and lamps)
- **Laser Products = 90-Day Limited Warranty**
- **L.E.D. Products = 2-year (730 days) Limited Warranty** (excluding motors, PCB boards, and power supplies, which have a 1-year (365 day Limited Warranty) and batteries which have a 180 day limited warranty).

SPECIFICATIONS

- DMX-512 LED effect that produces RGBW (red, green, blue & white) colored beams from 48 lenses
- 2 DMX Channel Modes: 2 Channel and 7 Channel
- Features 2 bright 10-watt RGBW Quad LED's
- Green Laser & Red laser
- Complies with FDA standards
- Multiple unique laser patterns
- Light in weight and portable for entertainers on the go!
- Strobe effect
- 3 Operating Modes: Show Mode, Sound Active, & DMX Control
- 3 Show Modes with adjustable speed control
- DMX-512 protocol
- With Wired Digital Communication Network
- UC IR Compatible (sold separately)
- 4-button DMX LED menu
- Stand Alone or Primary/Secondary Configuration
- Includes hanging bracket
- Run all night – no duty cycle
- Power consumption: 33 W maximum
- Integrated 3-pin XLR In/Out connections
- Long life LEDs (50,000 hr. rating)
- Multi-voltage operation: AC 100V-240V 50/60Hz
- Dimensions per unit (LxWxH): 8" x 7.75" x 8.5" / 205 x 198 x 218mm (with Bracket)
/ 8" x 7.75" x 5.75" / 205 x 198 x 147mm (without Bracket)
- Weight (per unit): 4 lbs. / 1.7kg.
- Laser Accession No. 1611085-000

Please Note: Specifications and improvements in the design of this unit and this manual are subject with change without any prior written notice.

This page intentionally left blank.

