



HYDRO HYBRID

User Manual

©2024 ADJ Products, LLC all rights reserved. Information, specifications, diagrams, images, and instructions herein are subject to change without notice. ADJ Products, LLC logo and identifying product names and numbers herein are trademarks of ADJ Products, LLC. Copyright protection claimed includes all forms and matters of copyrightable materials and information now allowed by statutory or judicial law or hereinafter granted. Product names used in this document may be trademarks or registered trademarks of their respective companies and are hereby acknowledged. All non-ADJ Products, LLC brands and product names are trademarks or registered trademarks of their respective companies.

ADJ Products, LLC and all affiliated companies hereby disclaim any and all liabilities for property, equipment, building, and electrical damages, injuries to any persons, and direct or indirect economic loss associated with the use or reliance of any information contained within this document, and/or as a result of the improper, unsafe, insufficient and negligent assembly, installation, rigging, and operation of this product.

Europe Energy Saving Notice

Energy Saving Matters (EuP 2009/125/EC)

Saving electric energy is a key to help protecting the environment. Please turn off all electrical products when they are not in use. To avoid power consumption in idle mode, disconnect all electrical equipment from power when not in use. Thank you!



LATEST VERSION

Due to additional product features and/or enhancements, an updated version of this document may be available online.

Please check www.adj.com for the latest revision/update of this manual before beginning installation and/or programming.

Date	Document Version	Software Version	DMX Channels	Notes
06/24/2024	1.0	1.0.1	24 / 27 / 32 Ch.	Initial release
07/24/2024	1.1	N/C	No Changes	Updated Specifications
08/29/2024	1.2	N/C	No Changes	Labeled fixed gobos
09/09/2024	1.3	N/C	No Changes	Updated System Menu & DMX Traits

CONTENTS

Introduction	4
Limited Warranty (USA Only)	5
Warranty Registration Features	6
IP65 Rated	7
Safety Precautions	8
Discharge Lamp Warning	10
Lamp Replacement	11
Overview	13
Installation Guidelines	14
Colors Animation Wheel	18
Gobos	19
Gobo Replacement	21
Remote Device Management (RDM)	22
System Menu	23
DMX Setup	26
DMX Traits	28
Color Macros Chart	33
Primary-Secondary Set Up Multi Unit Power Linking	34
Maintenance Guidelines	35
Torque Settings for Screws	36
IP Test Parameters	37
Error Codes	38
Dimensional Drawings	39
Specifications	40
FCC Statement	41

INTRODUCTION

Unpacking: Thank you for purchasing the Hydro Hybrid by ADJ Products, LLC. Every device has been thoroughly tested and has been shipped in perfect operating condition. Carefully check the shipping carton for damage that may have occurred during shipping. If the carton appears to have been damaged, carefully inspect your fixture for any damage and be sure all accessories necessary to operate the unit have arrived intact. In the event that damage has been found or parts are missing, please contact our toll free customer support number for further instructions. Do not return this unit to your dealer without first contacting customer support.

Introduction: Part of ADJ's Hydro Series, the Hydro Hybrid is a IP65-rated hybrid moving head that produces a beam, spot and wash effect powered by a 420-Watt Osram SIRIUS HRI discharge lamp. **This product is intended to be used by professionally trained personnel only and is not suitable for private use.**

Customer Support: Contact ADJ Service for any product related service and support needs. Also visit forums.adj.com with questions, comments or suggestions.

Parts: To purchase parts online visit:

<http://parts.adj.com> (US)

<http://www.adjparts.eu> (EU)

ADJ SERVICE USA - Monday - Friday 8:00am to 4:30pm PST

Voice: 800-322-6337 | support@adj.com

ADJ SERVICE EUROPE - Monday - Friday 08:30 to 17:00 CET

Voice: +31 45 546 85 60 | **Fax: +31 45 546 85 96** | support@adj.eu

ADJ PRODUCTS LLC USA

6122 S. Eastern Ave. Los Angeles, CA. 90040

323-582-2650 | www.adj.com | info@adj.com

ADJ SUPPLY Europe B.V

Junostraat 2 6468 EW Kerkrade, The Netherlands

+31 (0)45 546 85 00 | Fax +31 45 546 85 99

www.adj.eu | info@adj.eu

ADJ PRODUCTS GROUP Mexico

AV Santa Ana 30 Parque Industrial Lerma, Lerma, Mexico 52000

+52 (728) 282-7070

CAUTION! There are no user serviceable parts inside this unit. Do not attempt any repairs yourself, as doing so will void your manufacturer's warranty. In the unlikely event your unit may require service, please contact ADJ Products, LLC.

Do not discard the shipping carton in the trash. Please recycle when ever possible.

LIMITED WARRANTY (USA ONLY)

- A. ADJ Products, LLC hereby warrants, to the original purchaser, ADJ Products, LLC products to be free of manufacturing defects in material and workmanship for a prescribed period from the date of purchase (see specific warranty period on reverse). This warranty shall be valid only if the product is purchased within the United States of America, including possessions and territories. It is the owner's responsibility to establish the date and place of purchase by acceptable evidence, at the time service is sought.
- B. For warranty service, you must obtain a Return Authorization number (RA#) before sending the product back—please contact ADJ Products, LLC Service Department at 800-322-6337. Send the product only to the ADJ Products, LLC factory. All shipping charges must be prepaid. If the requested repairs or service (including parts replacement) are within the terms of this warranty, ADJ Products, LLC will pay return shipping charges only to a designated point within the United States. If the entire instrument is sent, it must be shipped in its original package and packaging material. No accessories should be shipped with the product. If any accessories are shipped with the product, ADJ Products, LLC shall incur no liability whatsoever for loss of or damage to any such accessories, nor for the safe return thereof.
- C. This warranty is void if the product serial number and/or labels are altered or removed; if the product is modified in any manner which ADJ Products, LLC concludes, after inspection, affects the reliability of the product; if the product has been repaired or serviced by anyone other than the ADJ Products, LLC factory unless prior written authorization was issued to purchaser by ADJ Products, LLC; if the product is damaged because it was not properly maintained as set forth in the product instructions, guidelines and/or user manual.
- D. This is not a service contract, and this warranty does not include maintenance, cleaning, or periodic checkup. During the period specified above, ADJ Products, LLC will replace defective parts at its expense with new or refurbished parts, and will absorb all expenses for warranty service and repair labor by reason of defects in material or workmanship. The sole responsibility of ADJ Products, LLC under this warranty shall be limited to the repair of the product, or replacement thereof, including parts, at the sole discretion of ADJ Products, LLC. All products covered by this warranty were manufactured after August 15, 2012, and bear identifying marks to that effect.
- E. ADJ Products, LLC reserves the right to make changes in design and/or improvements upon its products without any obligation to include these changes in any products theretofore manufactured.
- F. No warranty, whether expressed or implied, is given or made with respect to any accessory supplied with products described above. Except to the extent prohibited by applicable law, all implied warranties made by ADJ Products, LLC in connection with this product, including warranties of merchantability or fitness, are limited in duration to the warranty period set forth above. And all warranties, whether expressed or implied, including warranties of merchantability or fitness, are limited in duration to the warranty period set forth above. The consumer's and/or dealer's sole remedy shall be such repair or replacement as is expressly provided above; and under no circumstances shall ADJ Product, LLC be liable for any loss and/or damage, direct and/or consequential arising out of the use of, and/or inability to use this product.
- G. This warranty is the only written warranty applicable to ADJ Products, LLC products, and supersedes all prior warranties and written descriptions of warranty terms and conditions heretofore published.

MANUFACTURER'S LIMITED WARRANTY PERIODS:

- Non-LED Lighting Products = 1-Year (365 Days) (Including Special Effect Lighting, Intelligent Lighting, UV lighting, Strobos, Fog Machines, Bubble Machines, Mirror Balls, Par Cans, Trussing, Lighting Stands, Power/Data Distribution, etc. excluding LED and lamps)
- Laser Products = 1-Year (365 Days) (excluding laser diodes which have a 6-Month Limited Warranty)
- LED Products = 2-Year (730 Days) (excluding batteries which have a 180 Day Limited Warranty)
- NOTE: 2-Year (730 Days) Limited Warranty ONLY applies to product purchased within the United States. StarTec Series = 1-Year (365 Days) (excluding batteries which have a 180 Day Limited Warranty)
- ADJ DMX Controllers = 2 Year (730 Days)
- American Audio Products = 1 Year (365 Days)

WARRANTY REGISTRATION

Please fill out the enclosed warranty card to validate your purchase. All returned service items, whether under warranty or not, must be freight pre-paid and accompanied by a return authorization (R.A.) number. The R.A. number must be clearly written on the outside of the return package. A brief description of the problem as well as the R.A. number must also be written down on a piece of paper included in the shipping carton. If the unit is under warranty, you must provide a copy of your proof of purchase invoice. You may obtain an R.A. number by contacting our customer support team. All packages returned to the service department not displaying an R.A. number on the outside of the package will be returned to the shipper.

FEATURES

- IP65 Rated Housing
- 420-Watt Osram Sirius HRI Lamp Power Source
- Two Prisms on Dual Planes
- Motorized Zoom and Focus
- 2 Gobo Wheels - 9 Rotating/Removeable Gobos and 14 Fixed Gobos
- CMY Color Mixing System
- 12 Colors on Built-In Color Wheel
- Preset White Color Temperature Macros
- Full Power Mode and Eco Mode
- Three DMX Channel Modes
- RDM

INCLUDED ITEMS

- Power Cable

IP65 RATED

The International Protection (IP) rating system is commonly expressed as “**IP**” (Ingress Protection) followed by two numbers (i.e. IP65), where the numbers define the degree of protection. The first digit (Foreign Bodies Protection) indicates the extent of protection against particles entering the fixture, and the second digit (Water Protection) indicates the extent of protection against water entering the fixture. An **IP65** rated lighting fixture is designed and tested to protect against the ingress of dust (6), and low-pressure water jets from any direction (5).

NOTE: THIS FIXTURE IS INTENDED FOR TEMPORARY OUTDOOR USE ONLY!

Maritime/Coastal Environment Installations: A coastal environment is seaside adjacent, and caustic to electronics through exposure to atomized salt-water and humidity, whereas maritime is anywhere within 5-miles of a coastal environment.



NOT suitable for maritime/coastal environment installations. Installing this fixture in a maritime/coastal environment may cause corrosion and/or excessive wear to the interior and/or exterior components of the fixture. Damages and/or performance issues resulting from installation in a maritime/coastal environment will void the manufactures warranty, and will NOT be subject to any warranty claims and/or repairs.

Maritime installations require additional preparation, and additional service intervals may be needed given the maritime use. In general, IP ratings presuppose freshwater conditions VS maritime conditions, which are typically more “caustic” to IP fixtures (both internally and externally). A duty-cycle may also be needed when units are not in use. During times of high humidity and colder temperatures, condensation may occur internally so the fixture may require a duty-cycle to bring it up to running temperature, allowing any accumulation of moisture to be expelled via the vent valve. Recommendations can change based on installation environmental circumstances. A waterproof dome or similar device is recommended for use in permanent outdoor installations. When using a dome, refer to manufacturer recommendations for duty-cycle.

NOTE: NOT ALL FEATURES LISTED ARE AVAILABLE ON ALL FIXTURES; THE FOLLOWING INSTRUCTIONS MAY NOT APPLY. CONTACT SUPPORT FOR ADDITIONAL DETAILS.

Exterior Maintenance: Inspect the exterior every 30-days. The unit must be powered off/disconnected. Inspect optics to determine if the lens is obstructed, then clean optics and chassis accordingly. Based on initial finding, schedule maintenance accordingly, keeping in mind that exterior maintenance will be required. Even if the luminaires are NOT in use, maintenance will still be needed given its location (exterior use). The use of a durable type of wax on the chassis is recommended since it will help prevent contaminant build up. Inspect both power and data lines for any signs of contaminants or corrosion. Periodically reapplying di-electric grease, especially in coastal environments. If any signs of corrosion/contaminants are present, clean thoroughly, and/or replace connectors, then reapply di-electric grease. Typically, this should be done annually, or any time an opportunity presents itself. As a preventive measure, annual replacement of both vent valves is recommended. The vent valve membrane can become contaminated and/or clogged causing improper venting of humidity within the luminaire. Inspect all mounting hardware as a precaution.

Interior Maintenance: Inspect the interior every 30-days. The unit must be powered off/disconnected.

- Inspect zoom/focus mechanism, clean optics, lubricate linear bearings (Krytox oil) as needed, inspect belts for wear
- Inspect all rotating effect wheels, manually rotate them, note any resistance
- Inspect all remaining rotating belts for any wear
- Inspect all fans, clean as needed, check rotation, check connections
- Inspect CMY module, manually move flags and check for signs of resistance, and if needed, clean guide rods first, then reapply a thin layer of grease (moly lube)
- Clean interior with low-volume compressed air, then clean optics prior to reassembly of head covers

Although the base has limited moving parts, the pan belt should also be inspected for wear. Remember to always perform an IP test anytime a cover is removed.

There is no specific time frame regarding the routine replacement of parts such as belts/stepper motors, PCBs, or LEDs. These items should only be replaced on an as needed bases, except for cooling fans, which should be replaced once the luminaries reach 10,000-hours. This is a prophylactic measure intended to keep the unit running as cool as possible, insuring proper function of all internal components. A complete service breakdown is available, please contact service@adj.com for any needed parts or manuals.

SAFETY PRECAUTIONS



**HIGH
INTENSITY
ULTRAVIOLET
LIGHT**

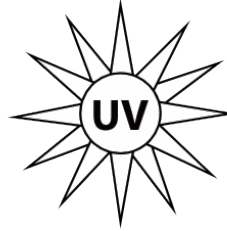

**AVOID DIRECT EYE & SKIN EXPOSURE.
WEAR PROPER EYE & SKIN PROTECTION.**

RISK GROUP 3 - RISK OF EXPOSURE TO ULTRAVIOLET UV RADIATION! THE FIXTURE EMITS A HIGH-INTENSITY WAVELENGTH OF ULTRAVIOLET UV LIGHT FROM THE UV COLOR FILTER. WEAR PROPER EYE AND SKIN PROTECTION.

AVOID PROLONGED PERIODS OF EXPOSURE TO THE UV COLOR FILTER.

AVOID WEARING WHITE CLOTHING AND/OR USING UV PAINTS ON THE SKIN.

AVOID DIRECT EYE AND/OR SKIN EXPOSURE AT DISTANCES LESS THAN 11 FEET (3.3M).

DO NOT OPERATE THE FIXTURE WITH DAMAGED/MISSING EXTERNAL COVERS.

DO NOT LOOK DIRECTLY INTO THE UV LIGHT AND/OR VIEW UV LIGHT DIRECTLY WITH OPTICAL INSTRUMENTS THAT MAY CONCENTRATE THE LIGHT/RADIATION OUTPUT.

INDIVIDUALS SUFFERING FROM A RANGE OF EYE CONDITIONS, SUNLIGHT EXPOSURE DISORDERS, OR INDIVIDUALS USING PHOTSENSITIVE MEDICATION MAY EXPERIENCE DISCOMFORT IF EXPOSED TO THE ULTRAVIOLET UV LIGHT EMITTED FROM THE UV LED.

SAFETY PRECAUTIONS



PROTECTION CLASS 1 - FIXTURE MUST BE PROPERLY GROUNDED.



THERE ARE NO USER SERVICEABLE PARTS INSIDE THIS UNIT. DO NOT ATTEMPT ANY REPAIRS YOURSELF, AS DOING SO WILL VOID YOUR MANUFACTURER'S WARRANTY. DAMAGES RESULTING FROM MODIFICATIONS TO THIS FIXTURE AND/OR THE DISREGARD OF SAFETY INSTRUCTIONS AND GUIDELINES IN THIS MANUAL VOID THE MANUFACTURER'S WARRANTY AND ARE NOT SUBJECT TO ANY WARRANTY CLAIMS AND/OR REPAIRS.



**NEVER LOOK DIRECTLY INTO THE LIGHT SOURCE!
RETINA INJURY RISK - MAY INDUCE BLINDNESS!
SENSITIVE PERSONS MAY SUFFER AN EPILEPTIC SHOCK!**

- **Maximum ambient operating temperature is 113°F (45°C)!**
- DO NOT TOUCH the fixture housing during operation. Disconnect the power and allow approximately 15 minutes for the fixture to cool down before servicing.
- DO NOT shake the fixture, and avoid brute force when installing and/or operating the fixture.
- DO NOT operate the fixture if the power cord has become frayed, crimped and/or damaged. If the power cord is damaged, replace immediately with a new one of the same power rating.
- DO NOT attempt to remove or break off the ground prong from the electrical cord. This prong is used to reduce the risk of electrical shock and fire in case of an internal short.
- DO NOT attempt to operate this unit if it has been damaged in any way.
- Disconnect from main power before making any type of connection.
- DO NOT block any air ventilation slots. All fan and air inlets must remain clean and never blocked. Allow approx. 6" (15cm) between fixture and other devices or a wall for proper cooling.
- Always be sure to mount this unit in an area that will allow proper ventilation. Allow about 6" (15cm) between this device and a wall.
- DO NOT remove the cover for any reason.
- When installing fixture in a suspended environment, always use mounting hardware that is no less than M10 x 25mm, and always install fixture with an appropriately rated safety cable.
- Never plug this unit in to a dimmer pack.
- During long periods of non-use, disconnect the unit's main power.
- Always mount this unit in safe and stable matter.
- Power-supply cords should be routed so that they are not likely to be walked on or pinched by items placed upon or against them, paying particular attention to the point where they exit from the unit.
- Cleaning - The fixture should be cleaned only as recommended by the manufacturer.
- Heat - The appliance should be situated away from heat sources such as radiators, heat registers, stoves, or other appliances (including amplifiers) that produce heat.
- The fixture should be serviced by qualified service personnel when:
 - A. The power-supply cord or the plug have been damaged.
 - B. Objects have fallen onto, or liquids have been spilled into, the fixture.
 - C. The fixture does not appear to operate normally or exhibits a marked change in performance.
 - D. The fixture has fallen and/or has been subjected to extreme handling.

DISCHARGE LAMP WARNING

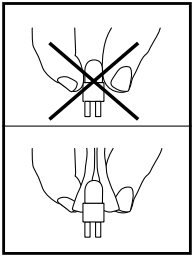

This fixture is equipped with a DISCHARGE LAMP, which is highly susceptible to damage if mishandled. NEVER touch the lamp with your bare hands, as the oil from your hands will shorten the lamp's life. NEVER move the fixture until the lamp has had ample time to cool. DISCHARGE LAMPS are NOT covered under warranty conditions. Avoid switching the fixture ON and OFF repeatedly in short intervals, as this will reduce lamp life and intensity. To achieve the intensity associated with discharge lamps, these lamps use gas sealed in a high-pressure environment to emit a brilliant output.

Due to the high pressure involved in the construction of the lamp, it **MAY EXPLODE DURING PROLONGED EXTENSIVE USE**. This risk increases with age; added care is encouraged when dealing with older lamps. Thus, the lamp must always be replaced at the end of its recommended duty cycle. Extreme caution should be used when operating this or any fixture fitted with a gas discharge lamp.

UV RADIATION NOTICE



THIS FIXTURE EMITS INTENSE UV RADIATION, WHICH IS HARMFUL TO THE EYES AND SKIN. THE INTENSE LUMINESCENCE OF THE LAMP CAN CAUSE SEVERE DAMAGE TO THE RETINA. NEVER OPERATE THIS FIXTURE WITH ANY OF THE PROTECTIVE COVERS REMOVED. THESE COVERS HAVE BEEN SPECIALLY DESIGNED TO SHIELD AGAINST UV RADIATION.

LAMP REPLACEMENT



USE ONLY GENUINE ORIGINAL OSRAM LAMPS. OTHER BRAND LAMPS WILL CAUSE DAMAGE AND VOID THE FIXTURE WARRANTY!



**DISCONNECT THE MAIN POWER SUPPLY BEFORE REPLACING THE LAMP!
THE FIXTURE MUST COOL FOR 15 MINUTES BEFORE REPLACING THE LAMP!
NEVER TOUCH THE LAMP WITH BARE HANDS; ALWAYS WEAR GLOVES!
OIL FROM HANDS WILL SHORTEN THE LIFE OF THE LAMP!**



MAKE SURE ALL COVERS/FIXTURES ARE REPLACED/SECURED BEFORE OPERATING THE FIXTURE TO PREVENT ANY RISK AND/OR DAMAGE TO THE EYE RETINA FROM UV RADIATION EXPOSURE!

LAMP REPLACEMENT

Caution: Always replace with the exact same type of lamp, unless otherwise specified by an authorized ADJ service technician. Replacing with anything other than the specified part can damage your unit and will void your manufacturer's warranty.

Warning: If you continue to blow lamps or fuses, STOP using the unit. Contact customer support for further instructions; you may have to return the unit for servicing. Continuing to use the unit may cause serious damage.

Lamp Replacement: Caution! Never attempt to change the lamp while the fixture is plugged in. Always disconnect the main power and allow the unit ample time to cool before attempting to replace the lamp. Please see the **Discharge Lamp Warning** section of this manual for important information regarding the discharge lamp.

PLEASE NOTE: If you choose to perform this procedure yourself, you **MUST** re-install and re-torque the designated screws as listed in the **TORQUE SETTINGS FOR SCREWS** section, then check for leakage in accordance with the directions in the **IP TEST PARAMETERS** section. This will ensure that the fixture maintains its IP65 rating after re-assembly. If you are not comfortable with performing these steps, contact ADJ Service for assistance.

1. Set the fixture on a flat, stable surface and engage both the pan and tilt locks. Loosen the screws holding the front and rear cover of the head in place, then remove both covers.
2. Locate the air guide nozzle assembly, and loosen the two screws holding it in place. Remove the air guide nozzle assembly.

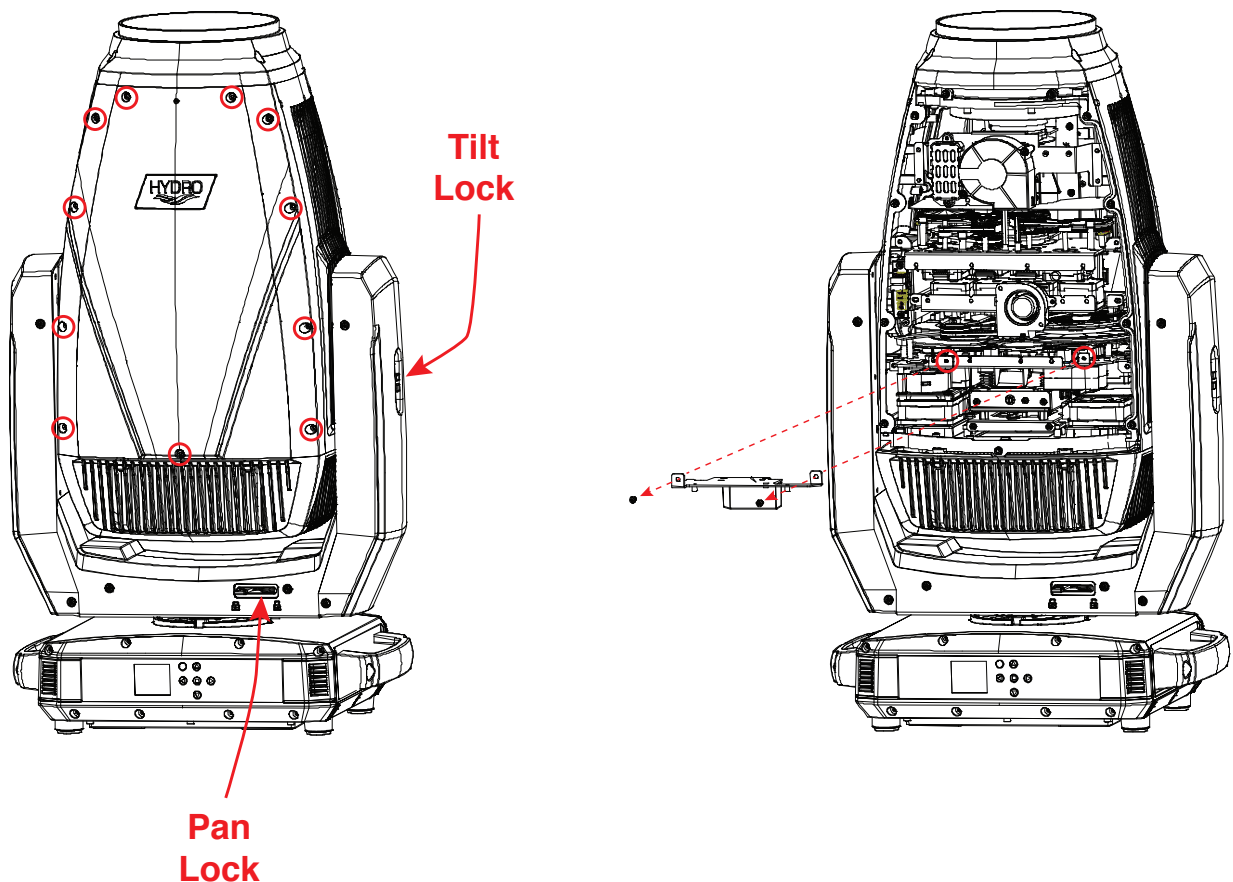

LAMP REPLACEMENT

3. Locate the bulb assembly, and loosen the two screws holding it in place. Remove the bulb assembly.
4. Carefully twist the bulb to detach it from the bulb assembly, then remove and replace with a new bulb. Re-assemble the fixture by reversing these instructions.

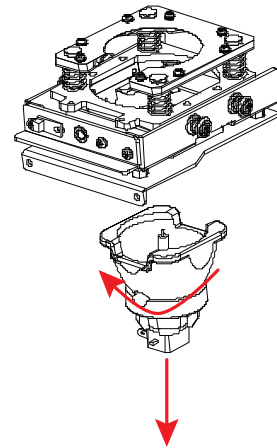
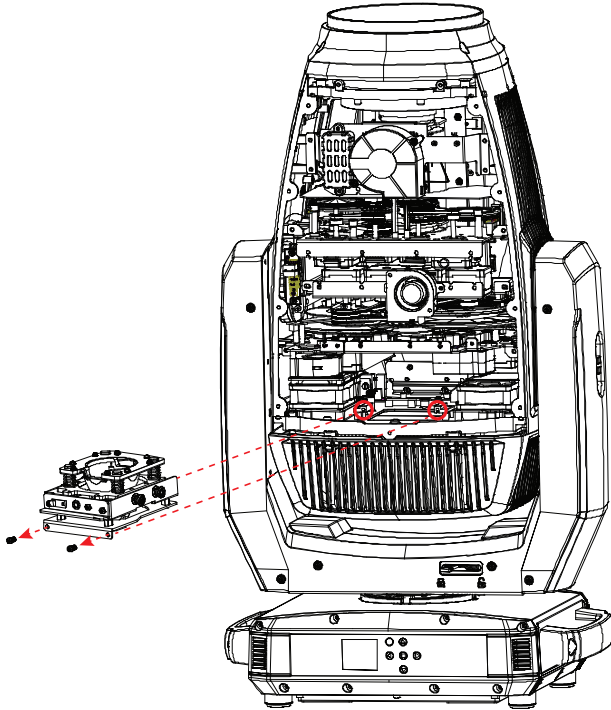

OVERVIEW

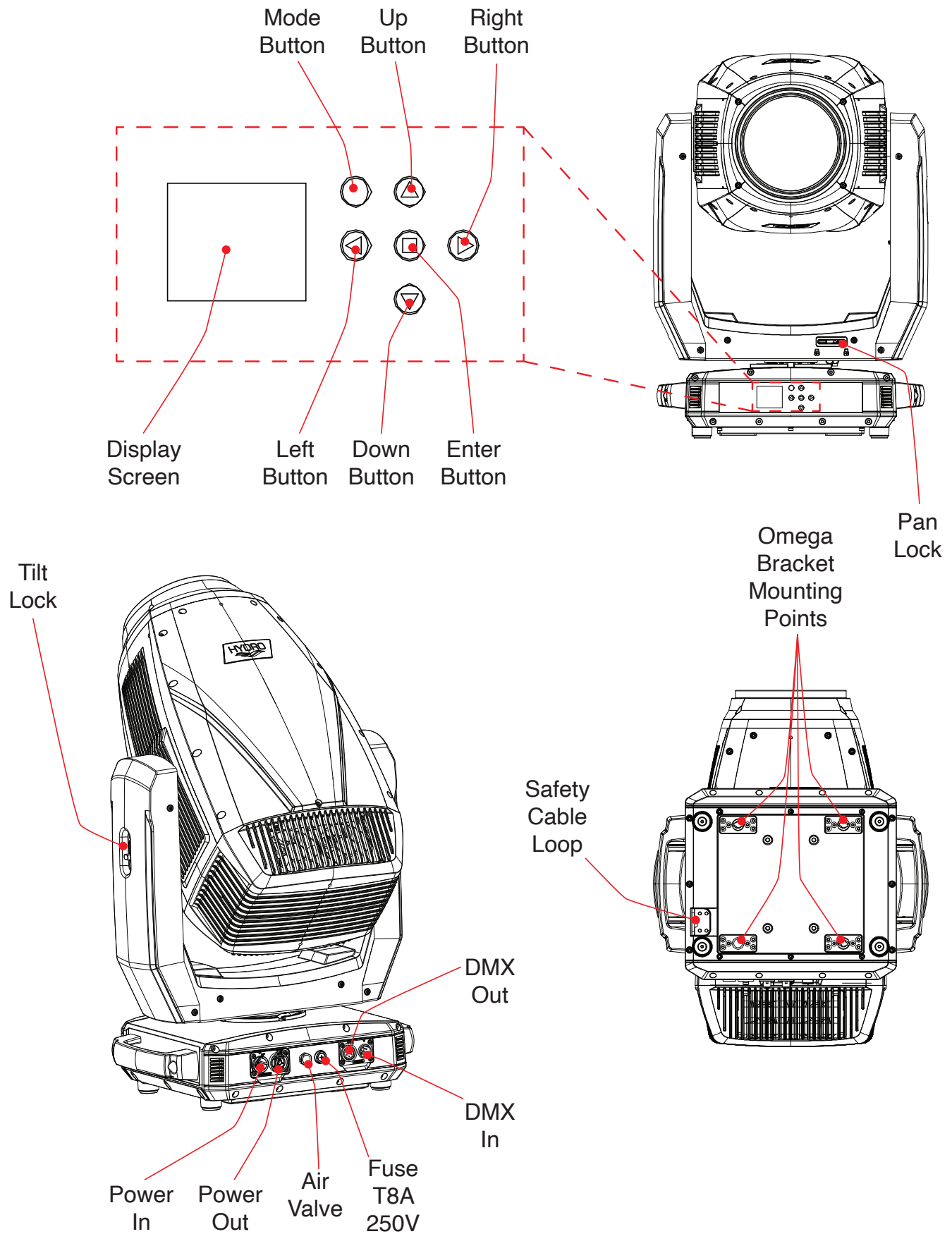

INSTALLATION GUIDELINES



DO NOT INSTALL THE FIXTURE IF YOU ARE NOT QUALIFIED TO DO SO!

Fixture **MUST** be installed following all local, national, and country commercial electrical and construction codes and regulations.

When installing the unit, the trussing or area of installation must be able to hold 10 times the weight of the unit and any attached accessories without any deformation. The unit must be secured with a secondary safety attachment, e.g. an appropriately-rated safety cable.

Before rigging/mounting a single fixture to any metal truss/structure or placing the fixture(s) on any surface, a professional equipment installer **MUST** be consulted to determine if the metal truss/structure or surface is properly certified to safely hold the combined weight of the fixture(s), clamps, cables, and accessories.

Ambient operating temperature range for this fixture is **-40°F to 113°F (-40°C to 45°C)**. Do not operate this device when ambient temperature exceeds this value!

Fixture(s) should be installed away from walking paths, seating areas, or areas where unauthorized personnel might reach the fixture by hand.

NEVER stand directly below the fixture(s) when rigging, removing, or servicing.

Overhead fixture installation must always be secured with a secondary safety attachment, such as an appropriately rated safety cable that can hold 10 times the weight of the fixture.

Overhead mounting requires extensive experience, including calculating working load limits, knowledge of installation material being used, and periodic safety inspection of all installation material as well as the unit itself. If you lack these qualifications, do not attempt the installation yourself.

The installation should be checked by a skilled person once a year.

INSTALLATION GUIDELINES

CLAMP MOUNTING

When mounting the fixture to a truss or any other suspended structure, secure an appropriately rated clamp to an Omega bracket using a properly rated nut and bolt, then attach the Omega bracket to the mounting points on the underside of the unit. **Please note that two clamps and two Omega brackets are required to securely install the unit.** Additionally, a safety cable of the appropriate weight rating should be secured through the safety cable loop located on the underside of the unit near the carrying handle.

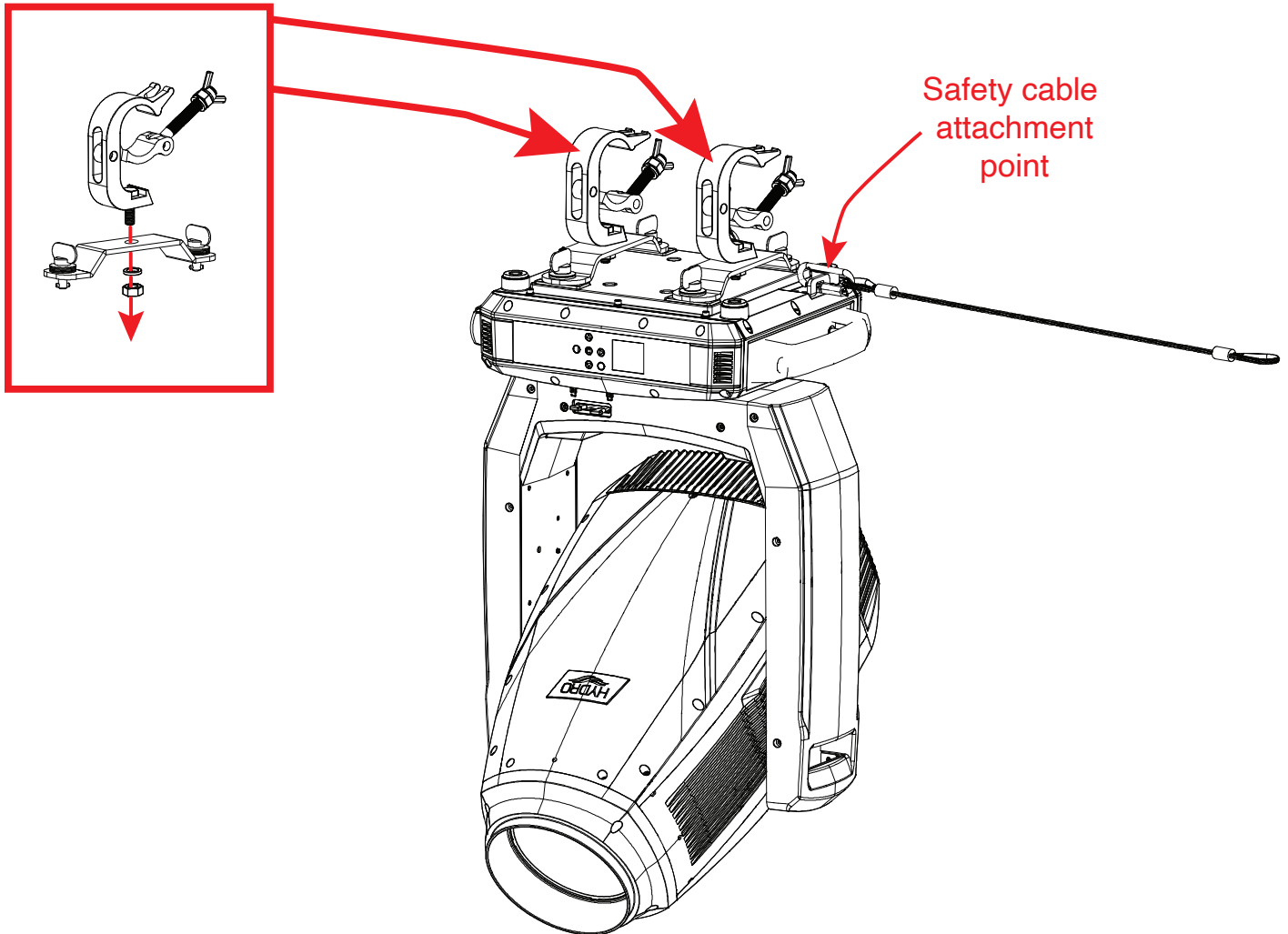

SAFETY CABLE:



ALWAYS ATTACH A SAFETY CABLE WHENEVER INSTALLING THIS FIXTURE IN A SUSPENDED ENVIRONMENT TO ENSURE THAT THE FIXTURE WILL NOT FALL IF THE CLAMP FAILS.

INSTALLATION GUIDELINES

POTENTIAL INTERNAL FIXTURE DAMAGE FROM EXTERNAL SOURCES OF LIGHT BEAMS

External sources of light beams from direct sunlight, lighting moving head fixtures, and lasers, which are focused directly towards the exterior housing and/or penetrate the front lens opening of ADJ lighting fixtures, can cause severe internal damage including burning to optics, dichroic color filters, glass and metal gobos, prisms, animation wheels, frost filters, iris, shutters, motors, belts, wiring, discharge lamps, and LEDs.

This issue is not specific only to ADJ lighting fixtures, it is a common issue with lighting fixtures from all manufacturers. Although there is no true way to fully prevent this issue from happening, the guidelines below can prevent any potential damage from occurring if followed. Contact ADJ Service for more details.

DO NOT EXPOSE THE FIXTURE AND/OR FRONT LENS OPENING TO LIGHT BEAMS FROM DIRECT SUNLIGHT, OTHER LIGHTING MOVING HEAD FIXTURES, AND LASERS WHILE UNPACKING, INSTALLATION, USE, AND EXTENDED IDLE TIMES OUTDOORS. DO NOT FOCUS A LIGHT BEAM FROM ONE LIGHTING FIXTURE DIRECTLY TOWARDS ANOTHER.

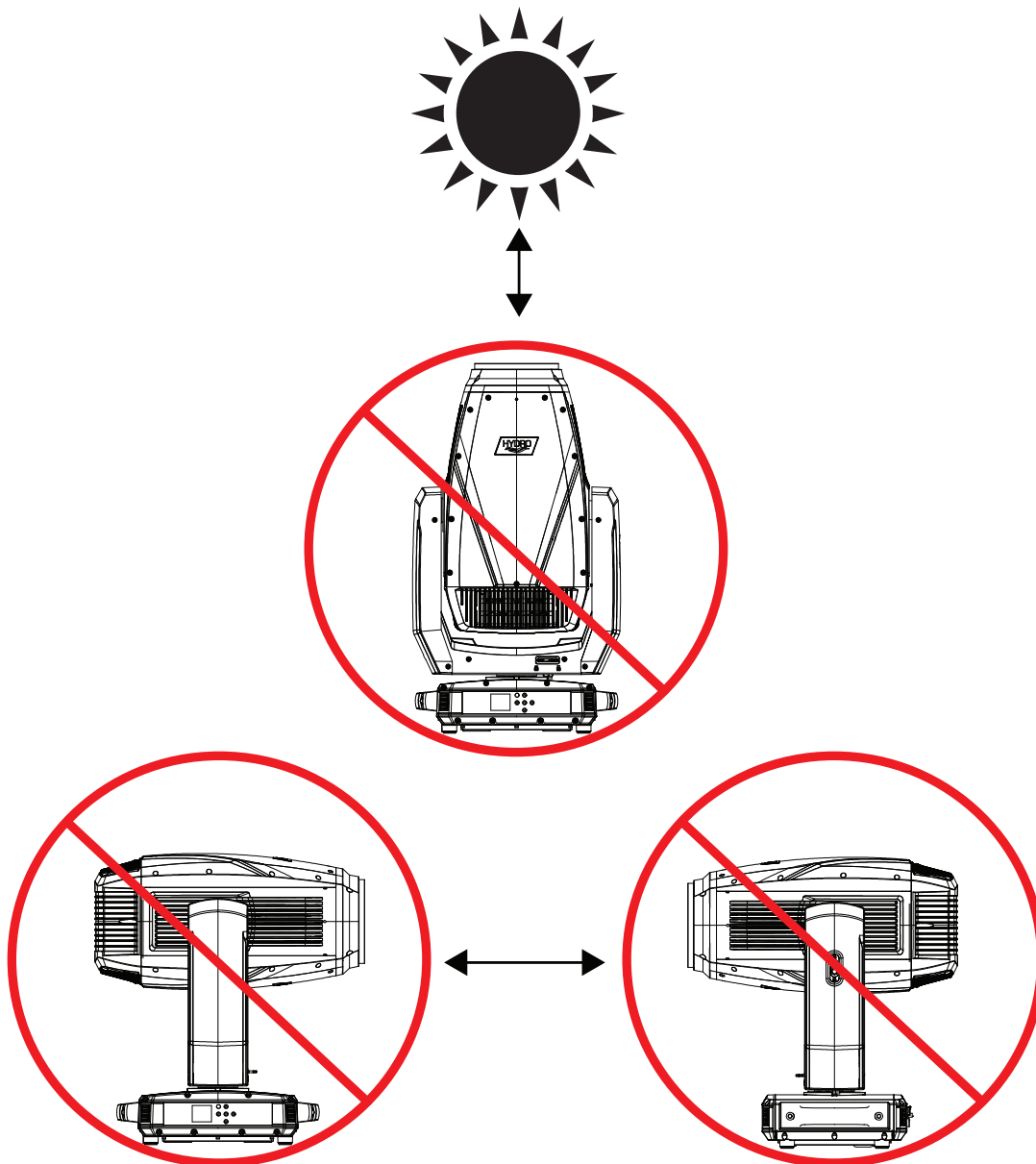

INSTALLATION GUIDELINES

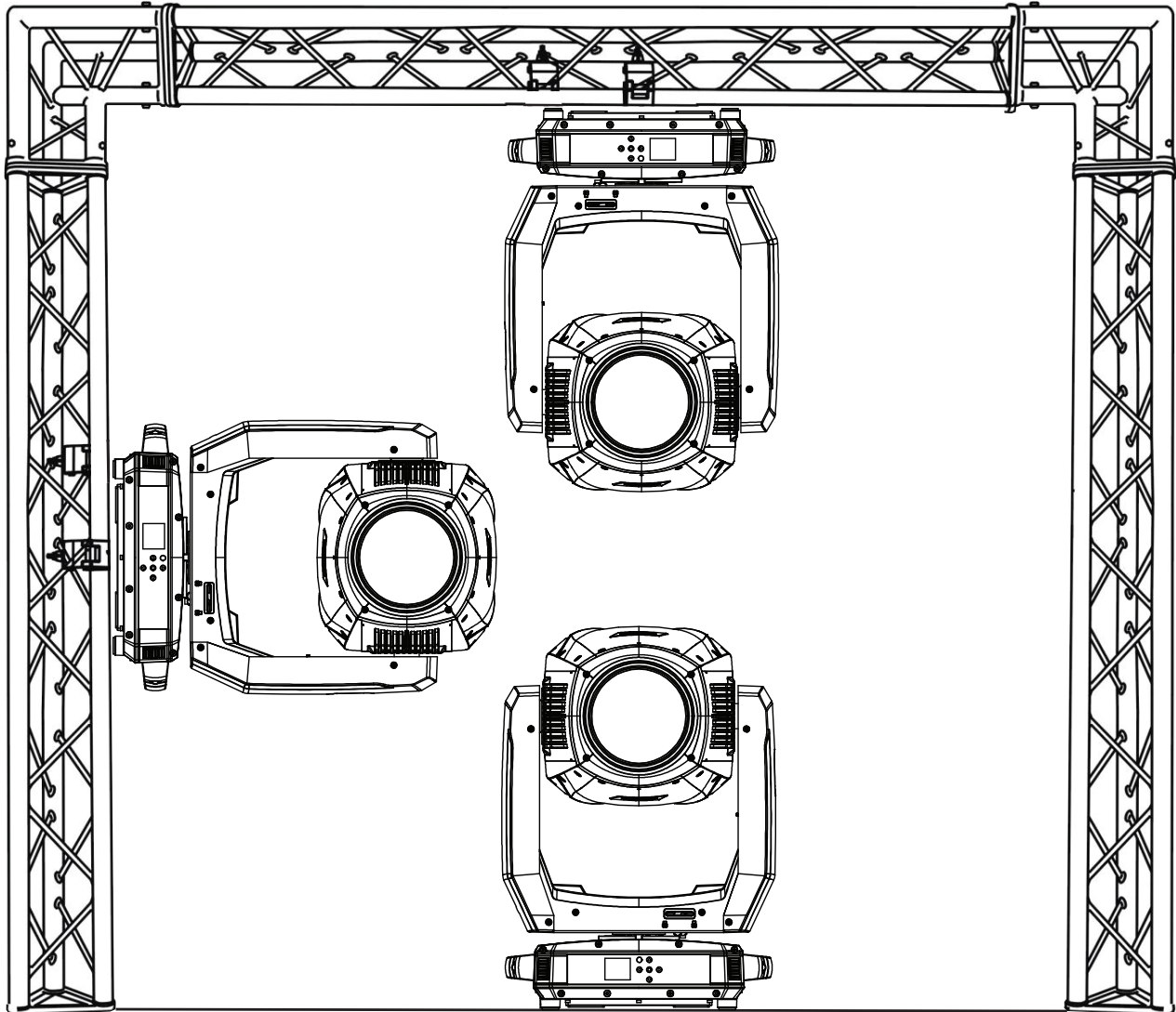

The unit is fully operational in three different mounting positions: hanging upside-down from the ceiling or trussing, sideways on trussing, or set on a flat level surface. Be sure this fixture is kept at least 12m (40ft) away from any flammable materials (decorations, etc). Always use and install a safety cable (not included) as a safety measure to prevent accidental damage and/or injury in the event the clamp fails. Never use the carrying handles for secondary attachment.



FALLING FIXTURES CAN CAUSE SEVERE INJURY OR SERIOUS EQUIPMENT DAMAGE! FOR THIS REASON, FIXTURES SHOULD BE INSTALLED AND INSPECTED ONLY BY QUALIFIED PERSONNEL. DO NOT INSTALL THE UNIT IF YOU LACK THE QUALIFICATIONS TO DO SO, OR IF YOU HAVE DOUBTS ABOUT THE SAFETY AND SECURITY OF THE INSTALLATION SETUP OR LOCATION!



ALWAYS ATTACH A SAFETY CABLE WHENEVER INSTALLING THIS FIXTURE IN A SUSPENDED ENVIRONMENT TO ENSURE THAT THE FIXTURE WILL NOT FALL IF THE CLAMP FAILS.

COLORS

COLOR WHEEL

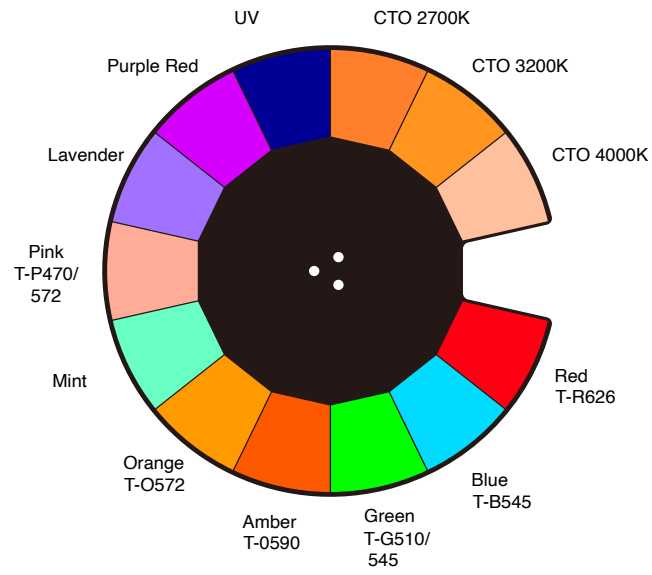

CMY

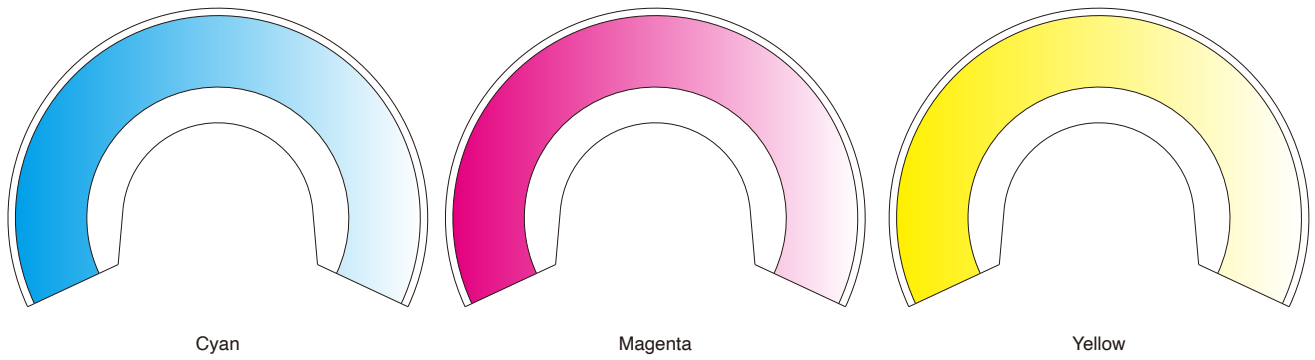

ANIMATION WHEEL

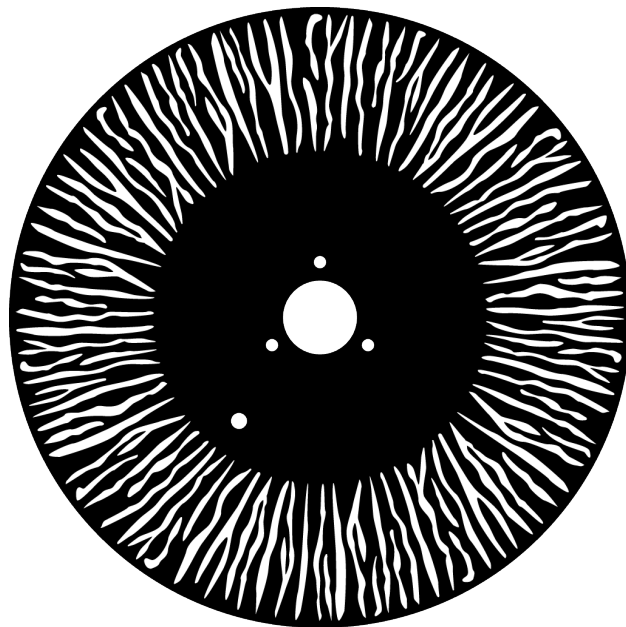

GOBOS

FIXED GOBOS

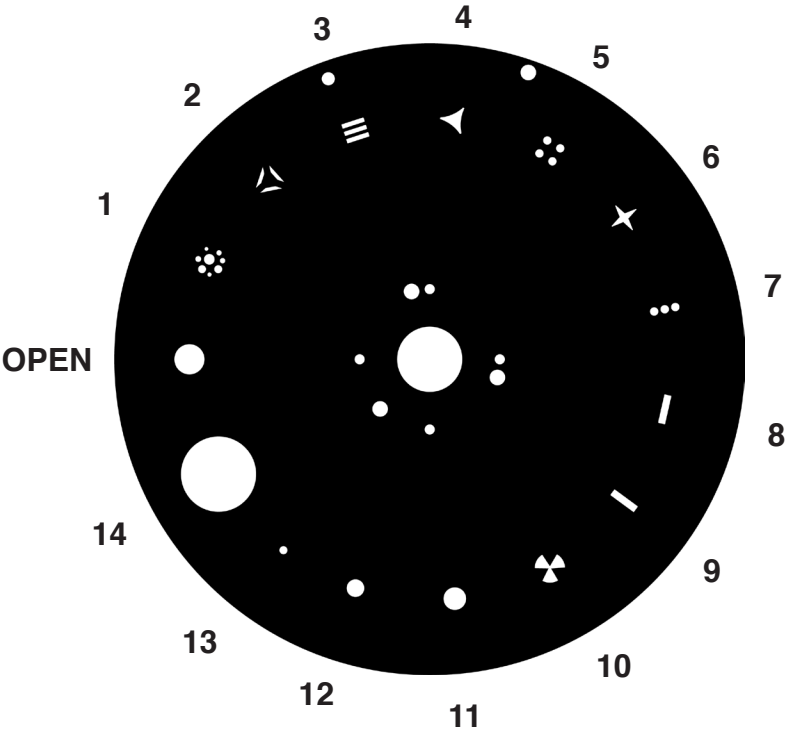

ROTATING GOBOS

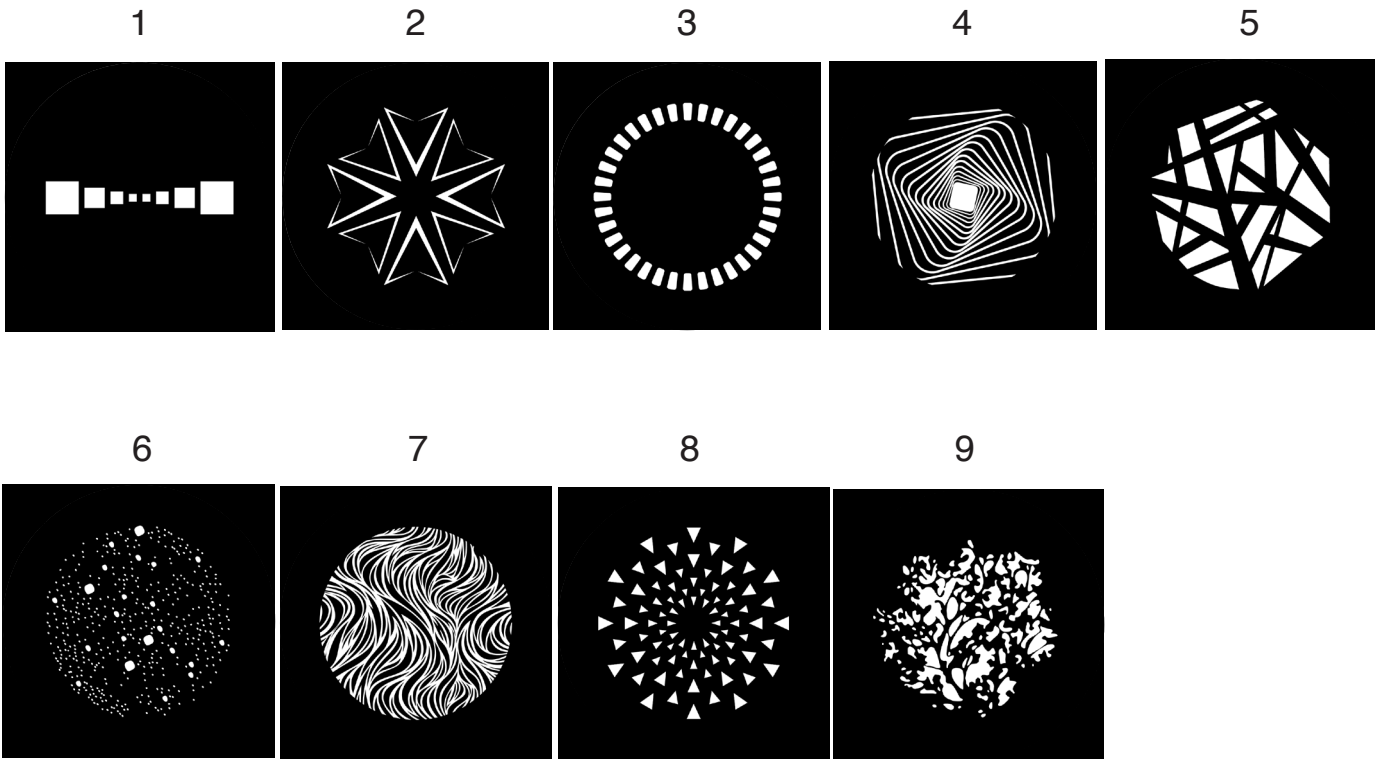

GOBOS

DIMENSIONS

ROTATING GOBO WHEEL DIMENSIONS	
Gobo O.D. (Max Outer Diameter)	ø 17mm
Gobo I.D. (Max Image Diameter)	ø 12mm
Gobo Thickness	1.1mm
Gobo Material	Glass

GOBO

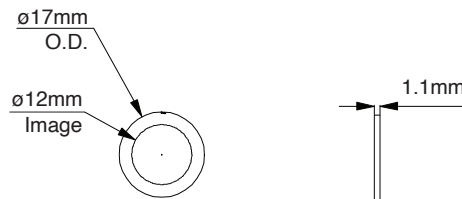

GOBO HOLDER

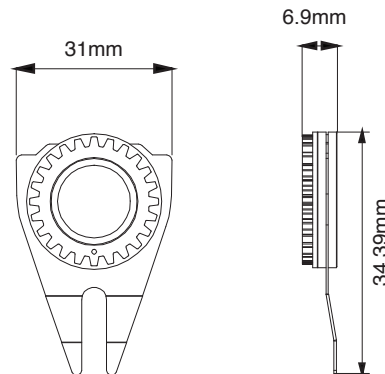

Please be aware of the intended position and correct sizing requirements of custom gobos.

***** IMPORTANT NOTICE REGARDING CUSTOM GOBOS *****

Due to the high temperature optical system, special material is required for custom gobos. Due to varying manufacturing processes and tolerances, it is highly recommended to provide a gobo sample and holder from the fixture to the custom gobo vendor for accurate sizing. Extended testing of custom gobo designs is highly recommended prior to use. Contact ADJ SERVICE for further information.

ADJ SERVICE USA - Monday - Friday 8:00am to 4:30pm PST

Voice: 800-322-6337 | support@adj.com

=====

ADJ SERVICE EUROPE - Monday - Friday 08:30 to 17:00 CET

Voice: +31 45 546 85 60 | Fax: +31 45 546 85 96 | support@adj.eu

GOBO REPLACEMENT

1. Set the fixture on a flat, stable surface, orient the head with the lens pointing upwards, and engage both the pan and tilt locks. Loosen the screws holding the front cover (on the same side as the pan lock) in place, then remove the cover.

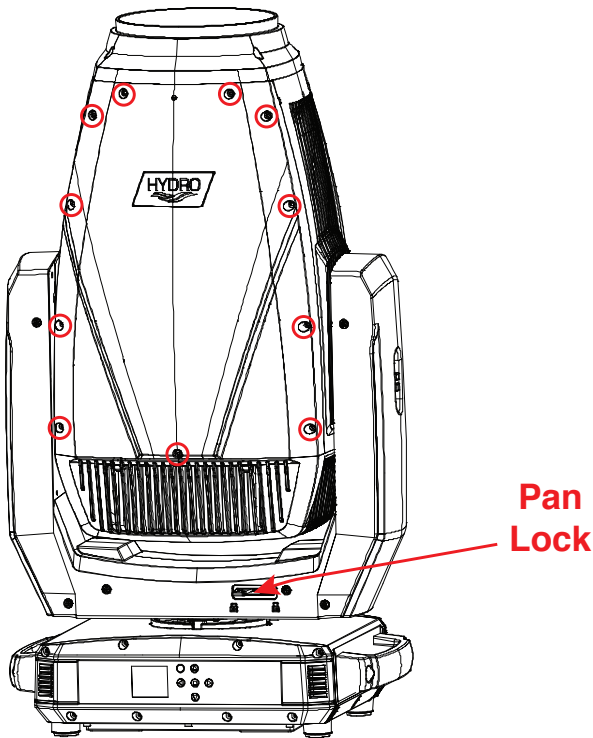

2. Locate the gobo module assembly, which can be identified by the small fan attached to the module. Loosen the two screws holding it in place and remove the gobo module assembly.

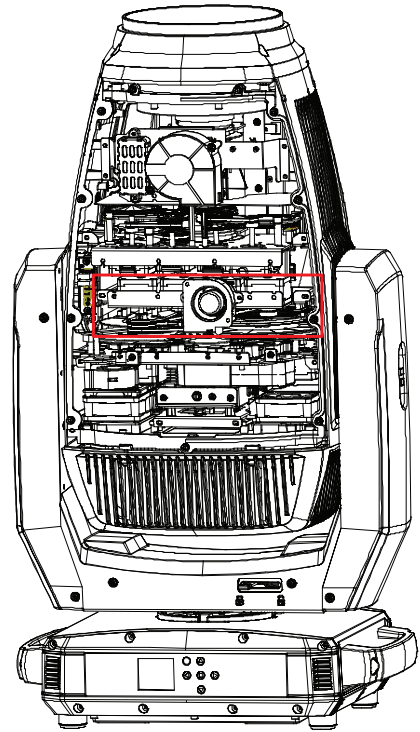

3. Firmly grasp the desired gobo holder, pulling downwards and away from the gobo wheel. When the gobo holder is clear of its slot, pull the gobo holder radially outward to remove the gobo holder from the gobo wheel.

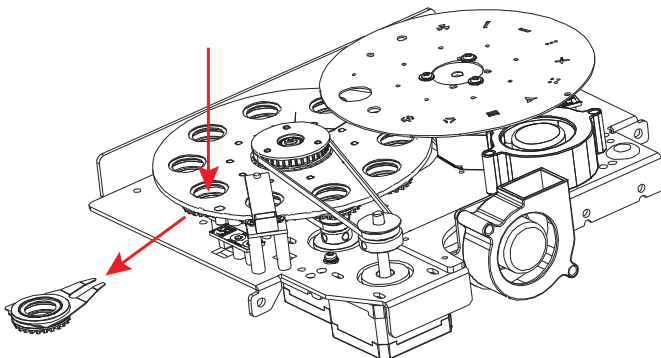

4. Remove the retainer ring by using a pick or similar tool to catch the tip of the ring, and use caution to avoid scratching or damaging the gobo. Remove the retainer ring from the gobo holder, then remove the gobo itself. Insert the new gobo, and reverse these steps to re-assemble.

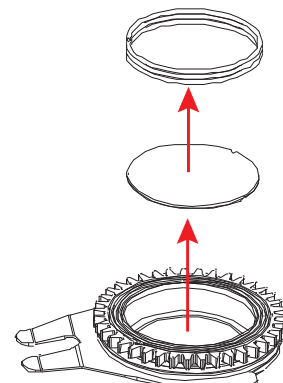

REMOTE DEVICE MANAGEMENT (RDM)

NOTE: In order for RDM to work properly, RDM enabled equipment must be used throughout the entire system, including DMX data splitters and wireless systems.

Remote Device Management (RDM) is a protocol that sits on top of the DMX512 data standard for lighting, allowing the DMX systems of the fixtures to be modified and monitored remotely. This protocol is ideal for instances in which a unit is installed in a location that is not easily accessible.

With RDM, the DMX512 system becomes bi-directional, allowing a compatible RDM enabled controller to send out a signal to devices on the wire, as well as allowing the fixture to respond (known as a *GET* command). The controller can then use its *SET* command to modify settings that would typically have to be changed or viewed directly via the unit's display screen, including the DMX Address, DMX Channel Mode, and Temperature Sensors.

FIXTURE RDM INFORMATION:

RDM Code	Device ID	Device Model ID	Personality ID
0x1900	44 0000-FFFF	44	Basic 24Ch (001) Standard 27Ch (002) Extended 32Ch (003)

Please be aware that not all RDM devices support all RDM features, and therefore it is important to check beforehand to ensure that the equipment that you are considering includes all of the features that you require.

[0x0011] Proxied Device Count	[0x0405] Device Power Cycles
[0x0200] Sensor Definition	[0x0600] Pan Invert
[0x0201] Sensor Value	[0x0601] Tilt Invert
[0x0080] Device Model Description	[0x0602] Pan Tilt Swap
[0x0081] Manufacturer Label	[0x0500] Display Invert
[0x0082] Device Label	[0x0501] Display Level
[0x00E0] DMX Personality	[0x0603] Realtime Clock
[0x00E1] DMX Personality Description	[0x1010] Power State
[0x0400] Device Hours	[0x1031] Preset Playback
[0x0015] Comms Status	[0x0122] Default Slot Value
[0x0031] Status ID Description	[0x00B0] Language
[0x0032] Clear Status ID	[0x00A0] Language Capabilities
[0x0401] Lamp Hours	[0x00C2] Boot Software Version Label
[0x0402] Lamp Strikes	[0x00C1] Boot Software Version ID
[0x0403] Lamp State	[0x0070] Product Detail ID List
[0x0404] Lamp Mode	[0x0030] Status Messages

SYSTEM MENU

This unit features a display screen with a 6-button control pad, which can be used to easily adjust any device settings.

Pressing the MODE button will cycle through the various Main Menu options. When the desired Main Menu option is displayed on the screen, press the ENTER button to enter the sub-menu, then use the UP, DOWN, LEFT, and RIGHT buttons to scroll through sub-menu options. In some cases, there will be a second sub-menu that can be navigated in the same way.

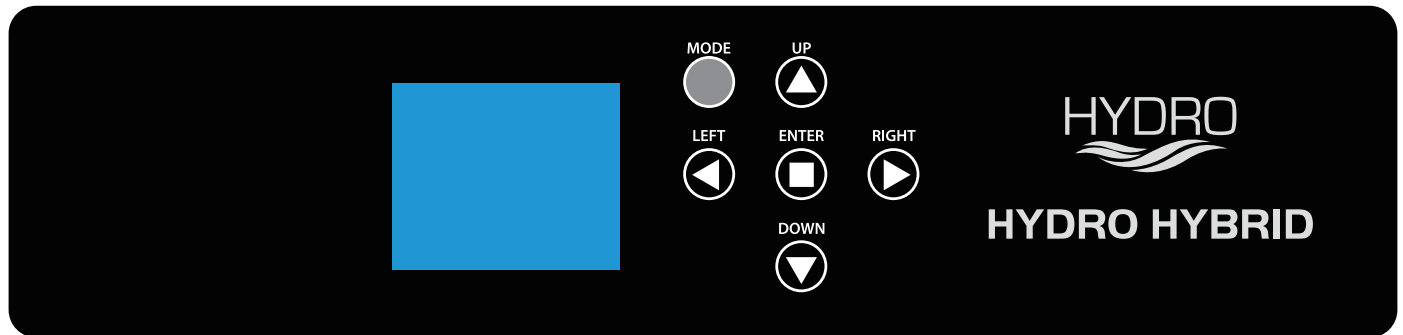

SCREEN LOCK

The control panel screen includes a feature that can be used to lock the control keys after a period of inactivity. This feature can be set or modified in the System Menu by navigating to Personality > Display > Key Lock.

- OFF: Control keys always remained unlocked.
- ON: Control keys lock after a period of inactivity, and can be unlocked by pressing and holding MODE for 3 seconds.
- ON1: Control keys lock after a period of inactivity, and can be unlocked by pressing UP, DOWN, UP, DOWN, ENTER.

SYSTEM MENU

MAIN MENU		OPTIONS / VALUES (Default Settings in BOLD)		
DMX Settings	DMX Address	001 - XXX, Basic 24, Standard 27 , Extended 32, User Mode		
	No DMX Status	Hold Last 2 , Hold Last, Blackout, Manual, Internal Programs		
Personality	Prim/Sec Mode	Primary, Secondary		
	Select Signal	DMX or Aria		
		Aria and DMX Out		
	Aria Settings	Frequency	2.4Ghz., Sub Gig US, Sub Gig EU	
		2.4 Ghz. CH	00~15	
		Sub Gig CH	00~09	
		Mesh	ON / OFF	
		RDM	ON / OFF	
		Bluetooth	ON / OFF	
		Status Settings	Pan Degree	630/540
	Pan Invert		ON / OFF	
	Tilt Invert		ON / OFF	
	P./T. Feedback		ON / OFF	
	P./T. Speed		Speed1	
			Speed2	
			Speed3	
	Hibernation		OFF, 01M~99M, 15M	
	Reset Motors	Reset All Motors	YES / NO	
		Pan/Tilt Reset	YES / NO	
		CMY Reset	YES / NO	
		Color Reset	YES / NO	
		Gobo Reset	YES / NO	
		...		
		Effect Reset	YES / NO	
	Display	Intensity	1-10	
		Display Invert	YES / NO	
		Screen Saver Delay	OFF-10M 05M	
		Display Flash	ON / OFF	
		Key Lock	OFF/ON/ ON1	
	Zoom Speed	Standard, Fast		
	Set User Mode	Pan	1	
		Pan Fine	2	
		Tilt	3	
		Tilt Fine	4	
		Cyan	5	
		Cyan Fine	6	
		Magneta	7	
		
		P/T Speed	32	
		Special	33	
	Service	Passcode	Effect Adjust (Calibration) 050	Pan 000-255
				Tilt 000-255
				Cyan 000-255
				Magenta 000-255
				Yellow 000-255
				Color 000-255
				...
			Factory Restore	OFF/ON Passcode 011

SYSTEM MENU

MAIN MENU	OPTIONS / VALUES (Default Settings in BOLD)		
Manual Control	Test		
	Pan	000-255	
	Pan Fine	000-255	
	Tilt	000-255	
	Tilt Fine	000-255	
	000-255	
	Pan/Tilt Speed	000-255	
Lamp Control	Lamp ON / OFF	ON / OFF	
	Lamp ON with Power	ON / OFF	
	Lamp ON via DMX	ON / OFF	
	Lamp OFF via DMX	ON / OFF	
Internal Programs	Program 1	Speed	000-255
		Fade	000-255
	Program 2	Speed	000-255
		Fade	000-255
	Program 3	Speed	000-255
		Fade	000-255
	Program 4	Speed	000-255
		Fade	000-255
	Program 5	Speed	000-255
		Fade	000-255
	Program 6	Speed	000-255
		Fade	000-255
	Program 7	Speed	000-255
		Fade	000-255
Information	Fixture Life Time	P-On Time-R	xxxxxx Hours
		P-On Time-Reset	xxxxxx Hours
		Power On Time Reset	Passcode
	Total Lamp Time	Lamp On Time	xxxxxx Hours
		Lamp On Time-R	xxxxxx Times
		Lamp Hours Reset	Passcode
	Fixture Temps	Head	xxx°
			xxx F / xxx C
			Max Resettable
		Base	xxx F / xxx C
			Max Not Resettable
			xxx F / xxx C
		Reset Head Temp	xxx F / xxx C
			Max Resettable
			xxx F / xxx C
	Fixture Humidity	Reset Base Temp	
		Passcode	
		Head 1 xxx%	
		Head 2 xxx%	
	Fan Info. (RPM)	Base xxx%	
		Base Fan	xxxx
		Lamp Fan	xxxx
		Head Fan 1	xxxx
		Head Fan 2	xxxx
		Head Fan 3	xxxx
	DMX Values	Pan	
		Tilt	
		...	
	Error Logs	Fixture Errors	List Errors one by one
		Reset Error Log	Passcode
	Software Version	1U:XXX	
		2U:XXX	
		3U:XXX	
	Aria ID	xx:xx:xx:xx:xx:xx	

DMX SETUP

DMX-512: DMX is short for Digital Multiplex. This is a universal protocol used as a form of communication between intelligent fixtures and controllers. A DMX controller sends DMX data instructions from the controller to the fixture. DMX data is sent as serial data that travels from fixture to fixture via the DATA “IN” and DATA “OUT” XLR terminals located on all DMX fixtures (most controllers only have a DATA “OUT” terminal).

DMX Linking: DMX is a language allowing all makes and models of different manufacturers to be linked together and operate from a single controller, as long as all fixtures and the controller are DMX compliant. To ensure proper DMX data transmission, try to use the shortest cable path possible when linking several DMX fixtures. The order in which fixtures are connected in a DMX line does not influence the DMX addressing. For example, a fixture assigned a DMX address of 1 may be placed anywhere in a DMX line: at the beginning, at the end, or anywhere in the middle. When a fixture is assigned a DMX address of 1, the DMX controller knows to send DATA assigned to address 1 to that unit, no matter where it is located in the DMX chain.

Data Cable (DMX Cable) Requirements (For DMX Operation): This unit can be controlled via DMX-512 protocol. The DMX address is set on the rear panel of the unit. Your unit and your DMX controller require a standard 5-pin XLR connector for data input and data output. We recommend Accu-Cable DMX cables. If you are making your own cables, be sure to use standard 110-120 Ohm shielded cable (This cable may be purchased at almost all pro lighting stores). Your cables should be made with a male XLR connector at one end and a female XLR connector at the other. Also remember that DMX cable must be daisy chained and cannot be split.

Notice: Be sure to follow the illustration below when making your own cables. Do not use the ground lug on the XLR connector. Do not connect the cable’s shield conductor to the ground lug or allow the shield conductor to come in contact with the XLR’s outer casing. Grounding the shield could cause a short circuit and erratic behavior.

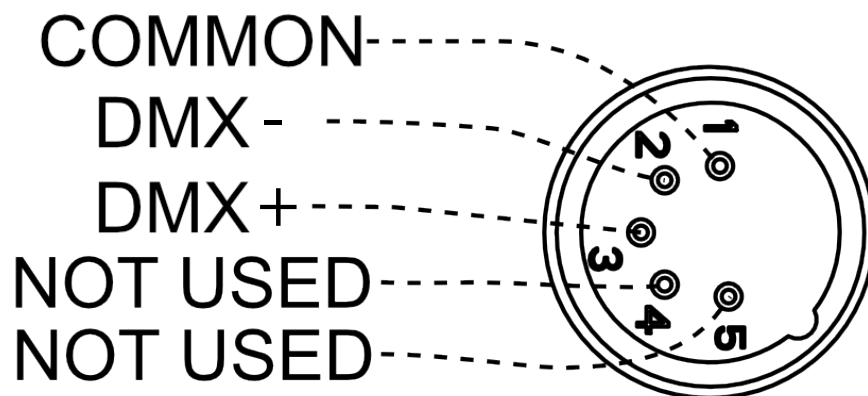

DMX SETUP

Special Note: Line Termination. When longer runs of cable are used, you may need to use a terminator on the last unit to avoid erratic behavior. A terminator is a 110-120 ohm 1/4 watt resistor which is connected between pins 2 and 3 of a male XLR connector (DATA + and DATA -). This unit is inserted in the female XLR connector of the last unit in your daisy chain to terminate the line. Using a cable terminator (ADJ part number Z-DMX/T) will reduce the risk of erratic behavior.

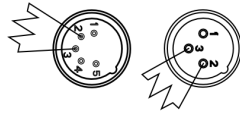

A DMX512 terminator reduces signal errors, avoiding most signal reflection interference. Connect PIN 2 (DMX-) and PIN 3 (DMX+) of the last fixture in series with a 120 Ohm, 1/4 W Resistor to terminate the DMX512.

DMX ADDRESSING.

All fixtures should be given a DMX starting address when using a DMX controller, so the correct fixture responds to the correct control signal. This digital starting address is the channel number from which the fixture starts to “listen” to the digital control signal sent out from the DMX controller. The assignment of this starting DMX address is achieved by setting the correct DMX address on the digital control display on the fixture.

You can set the same starting address for all fixtures or a group of fixtures, or set different addresses for each individual fixture. Setting all fixtures to the same DMX address will cause all fixtures to react in the same way. In other words, changing the settings of one channel will affect all the fixtures simultaneously.

If you set each fixture to a different DMX address, each unit will start to “listen” to the channel number you have set, based on the quantity of DMX channels of each fixture. That means changing the settings of one channel will only affect the selected fixture.

For example, when this unit is operating in 24 channel mode, you should set the starting DMX address of the first unit to 1, the second unit to 25 (1 + 24), the third unit to 49 (1 + 24 + 24), and so on. See the chart below for more details.

CHANNEL MODE	UNIT 1 ADDRESS	UNIT 2 ADDRESS	UNIT 3 ADDRESS	UNIT 4 ADDRESS
24Ch	1	25	49	73
27Ch	1	28	55	82
32Ch	1	33	65	97

DMX TRAITS

CHANNEL			DMX VALUES	FUNCTION
Basic 24CH	Standard 27CH	Extended 32CH		
1	1	1	0-255	Pan , Pan Movement (540/630)
	2	2	0-255	Pan Fine , Pan Fine
2	3	3	0-255	Tilt , Tilt Movement (270)
	4	4	0-255	Tilt Fine , Tilt Fine
3	5	5	0-255	Cyan , 0% to 100%
		6	0-255	Cyan Fine , 0% to 100%
4	6	7	0-255	Magenta , 0% to 100%
		8	0-255	Magenta Fine , 0% to 100%
5	7	9	0-255	Yellow , 0% to 100%
		10	0-255	Yellow Fine , 0% to 100%
6	8	11		Color
			0-4	Color (open)
			5-9	Red
			10-14	Blue
			15-19	Green
			20-24	Amber
			25-29	Orange
			30-34	Mint
			35-39	Pink
			40-44	Lavender
			45-49	Fucia
			50-54	UV
			55-59	2700K
			60-64	3200K
			65-69	4000K
			70-74	Open
			75-79	Open - Red
			80-84	Red
			85-89	Red - Blue
			90-94	Blue
			95-99	Blue - Green
			100-104	Green
			105-109	Green - Amber
			110-114	Amber
			115-119	Amber - Orange
			120-124	Orange
			125-129	Orange - Mint
			130-134	Mint
			135-139	Mint - Pink
			140-144	Pink
			145-149	Pink - Lavender
			150-154	Lavender
			155-159	Lavender - Fucia
			160-164	Fucia
			165-169	Fucia - UV
			170-174	UV
			175-179	UV - 2700K
			180-184	2700K
			185-189	2700K - 3200K
			190-194	3200K
			195-199	3200K - 4000K
			200-204	4000K
			205-209	4000K - Open
			210-212	Open
			213-232	Color Wheel rot. Fast-> Slow, CW
			233-235	Color Wheel rot. Stop
			236-255	Color Wheel rot. Slow-> Fast, CCW

DMX TRAITS

CHANNEL			DMX VALUES	FUNCTION
Basic 24CH	Standard 27CH	Extended 32CH		
7	9	12		Color Macros - CMY and Color Wheel
			0-31	OFF
			32-39	Macro1
			40-47	Macro2
			48-55	Macro3
			56-63	Macro4
			64-71	Macro5
			72-79	Macro6
			80-87	Macro7
			88-95	Macro8
			96-103	Macro9
			104-111	Macro10
			112-119	Macro11
			120-127	Macro12
			128-135	Macro13
			136-143	Macro14
			144-151	Macro15
			152-159	Macro16
			160-167	Macro17
			168-175	Macro18
			176-183	Macro19
			184-191	Macro20
			192-199	Macro21
			200-207	Macro22
			208-215	Macro23
			216-223	Macro24
			224-231	Macro25
			232-239	Macro26
			240-247	Macro27
			248-255	Random CMY
8	10	13		Gobo Wheel 1
			0-2	Beam Mode
			3-5	Spot Mode
			6-15	Gobo 1
			16-25	Gobo 2
			26-35	Gobo 3
			36-45	Gobo 4
			46-55	Gobo 5
			56-65	Gobo 6
			66-75	Gobo 7
			76-85	Gobo 8
			86-95	Gobo 9
			96-105	Gobo 1 shake (slow-fast)
			106-115	Gobo 2 shake (slow-fast)
			116-125	Gobo 3 shake (slow-fast)
			126-135	Gobo 4 shake (slow-fast)
			136-145	Gobo 5 shake (slow-fast)
			146-155	Gobo 6 shake (slow-fast)
			156-165	Gobo 7 shake (slow-fast)
			166-175	Gobo 8 shake (slow-fast)
			176-190	Gobo 9 shake (slow-fast)
			191-192	Open
			196-223	Gobo Wheel rot. Slow -> Fast, CW
			224-224	Gobo Wheel rot. Stop
			225-255	Gobo Wheel rot. Fast -> Slow, CCW

DMX TRAITS

CHANNEL			DMX VALUES	FUNCTION
Basic 24CH	Standard 27CH	Extended 32CH		
9	11	14		Gobo 1 Rotation
			0-5	Gobo1 Rot. Off
			6-128	Gobo Position 0° ... 540°
			129-191	Gobo Rotation, Slow -> Fast, CW
			192-192	Gobo Rotation Stop
			193-255	Gobo Rotation, Fast -> , CCW
10	12	15		Gobo Wheel 2 (Static)
			0-2	Open
			3-11	Gobo 1
			12-20	Gobo 2
			21-29	Gobo 3
			30-38	Gobo 4
			39-47	Gobo 5
			48-56	Gobo 6
			57-65	Gobo 7
			66-74	Gobo 8
			75-83	Gobo 9
			84-92	Gobo 10
			93-101	Gobo 11
			102-110	Gobo 12
			111-119	Gobo 13
			120-128	Gobo 14
			129-131	Open
			132-135	Gobo 1 shake (slow-fast)
			136-139	Gobo 2 shake (slow-fast)
			140-143	Gobo 3 shake (slow-fast)
			144-147	Gobo 4 shake (slow-fast)
			148-151	Gobo 5 shake (slow-fast)
			152-155	Gobo 6 shake (slow-fast)
			156-159	Gobo 7 shake (slow-fast)
			160-163	Gobo 8 shake (slow-fast)
			164-167	Gobo 9 shake (slow-fast)
			168-171	Gobo 10 shake (slow-fast)
			172-175	Gobo 11 shake (slow-fast)
			176-179	Gobo 12 shake (slow-fast)
			180-183	Gobo 13 shake (slow-fast)
			184-187	Gobo 14 shake (slow-fast)
			188-191	Open
			192-223	Gobo Wheel rot. Slow -> Fast, CW
			224-224	Gobo Wheel rot. Stop
			225-255	Gobo Wheel rot. Fast -> Slow, CCW
11	13	16		Shutter
			0-31	Shutter closed
			32-63	Shutter open
			64-95	Slow to fast strobe
			96-127	No action, shutter open
			128-159	Slow to fast pulse effect
			160-191	No action, shutter open
			192-223	Slow to fast random strobe
			224-255	No action, shutter open

DMX TRAITS

CHANNEL			DMX VALUES	FUNCTION
Basic 24CH	Standard 27CH	Extended 32CH		
12	14	17	0-255	Dimmer , Dimmer Intensity 0 to 100%
	15	18	0-255	Dimmer Fine , Dimmer Intensity Fine
13	16	19		Prism 1
			0-5	No Prism
			6-255	Prism on
14	17	20		Prism 1 Rotation
			0-5	Prism 1 Rot. Off
			6-128	Prism 1 Position 0 ... 540°
			129-191	Prism 1 Rotation, Slow -> Fast, CW
			192-192	Prism 1 Rotation Stop
			193-255	Prism 1 Rotation, Fast -> Slow, CCW
15	18	21		Prism 2
			0-5	No Prism
			6-255	Prism on
16	19	22		Prism 2 Rotation
			0-5	Prism 2 Rot. Off
			6-128	Prism 2 Position 0 ... 540°
			129-191	Prism 2 Rotation, Slow -> Fast, CW
			192-192	Prism 2 Rotation Stop
			193-255	Prism 2 Rotation, Fast -> Slow, CCW
17	20	23		Prism / Gobo Macros
			0-14	No Prism - Open
			15-29	Macro1
			30-44	Macro2
			45-59	Macro3
			60-74	Macro4
			75-89	Macro5
			90-104	Macro6
			105-119	Macro7
			120-134	Macro8
			135-149	Macro9
			150-164	Macro10
			165-179	Macro11
			180-194	Macro12
			195-209	Macro13
			210-224	Macro14
			225-239	Macro15
			240-255	Macro16
18	21	24	0-255	Focus , 0% to 100%
		25	0-255	Focus Fine , 0% to 100%
19	22	26	0-255	Zoom , Narrow to wide
		27	0-255	Zoom Fine , 16-bit Narrow to wide
20	23	28	0-255	Frost , 0% to 100%

DMX TRAITS

CHANNEL			DMX VALUES	FUNCTION
Basic 24CH	Standard 27CH	Extended 32CH		
21	24	29		Animation Index, Animation Rotation
			0-5	Open
			6-127	Animation indexing
			128-189	Clockwise animation rotation from fast to slow
			190-193	No rotation
22	25	30	194-255	Counter-clockwise animation rotation from slow to fast
			0-255	CMY / Color Macro Speed Max -> Min
23	26	31		Pan/Tilt Speed
			0-225	Pan/Tilt Fast -> Slow
			226-235	Blackout by Movement
			236-245	Blackout by all wheels changing
			246-255	No function
24	27	32		Special Functions
			0-89	No function
			90-99	Aria ON (Default) (Hold 3s)
			100-109	Aria OFF (Hold 5s)
			110-119	Lamp On (Hold 3s)
			120-129	Lamp Off (Hold 5s)
			130-139	Invert Pan on (Hold 3s)
			140-149	Invert Pan off (Hold 5s)
			150-159	Invert Tilt on (Hold 3s)
			160-169	Invert Tilt off (Hold 5s)
			170-179	Display Backlight ON (Hold 3s)
			180-189	Display Backlight OFF (Hold 5s)
			190-199	Hibernation Enable (Hold 3s)
			200-209	Hibernation OFF (Hold 5s)
			210-214	Color Reset (Hold 3s)
			215-219	Gobo Reset (Hold 3s)
			220-224	Focus and Zoom Reset (Hold 3s)
			225-229	Shutter Reset (Hold 3s)
			230-234	Reset Pan/Tilt (Hold 3s)
			235-239	Reset Head Only (Hold 3s)
			240-244	Reset Effects (Hold 3s)
			245-249	Reset All Functions (Hold 3s)
			250-255	No Function

COLOR MACROS CHART

MACRO NO.	COLOR WHEEL	CYAN	MAGENTA	YELLOW
Macro1	0	128	128	0
Macro2	0	255	128	0
Macro3	0	128	255	0
Macro4	0	0	128	255
Macro5	0	0	255	128
Macro6	0	128	0	255
Macro7	0	255	0	128
Macro8	0	0	128	128
Macro9	0	128	0	128
Macro10	0	0	255	170
Macro11	0	255	128	128
Macro12	0	128	255	128
Macro13	0	128	128	255
Macro14	0	46	13	206
Macro15	0	0	255	255
Macro16	0	255	0	255
Macro17	0	255	255	0
Macro18	0	133	207	124
Macro19	0	228	170	124
Macro20	0	23	28	157
Macro21	0	94	157	169
Macro22	0	176	203	112
Macro23	0	125	85	60
Macro24	0	205	117	96
Macro25	0	221	119	227
Macro26	0	0	0	255
Macro27	30	0	153	0
Random CMY	Random	Random	Random	Random

PRIMARY-SECONDARY SETUP

This function allows you to link units together to run in a Primary-Secondary set-up, in which one unit will act as the controlling unit and the others will react to the controlling unit's built-in programs. Any unit can be configured to act as a Primary or as a Secondary, but only one unit in a given system can be programmed to act as the Primary.

Primary-Secondary Connections and Settings:

1. Daisy chain your units via the XLR connectors on the rear panels of each unit. Use standard XLR data cables to link your units together. Remember that the male XLR connector is the input and the female XLR connector is the output. The first unit in the chain (primary) will use the female XLR connector only. The last unit in the chain will use the male XLR connector only.
2. On the unit that you want to designate as the primary, use the display screen and control panel to navigate to Personality > Prim/Sec Mode, and press the ENTER button to confirm. Use the UP or DOWN button to toggle this setting to "Primary". The device is now configured as the primary unit. Configure the unit's desired programming.
3. On the units that you want to designate as secondaries, use the display screen and control panel to navigate to Personality > Prim/Sec Mode, and press the ENTER button to confirm. Use the UP or DOWN button to toggle this setting to "Secondary". The device is now configured as secondary unit which will follow the behavior of the primary unit.

NOTES:

- Only one unit should be configured as the primary, while all the other units should be configured as secondaries.
- All units should be set to the same DMX channel mode.
- If fixtures fail to sync, verify that all settings mentioned above are the same, then power all devices off, then switch them on again to re-establish the link.

MULTI UNIT POWER LINKING

This feature allows you to connect the fixtures to one another using the power cable input and output sockets.

The maximum number of units that can be linked in this manner is as follows:

- 2 units when running on 120V power.
- 4 units when running on 230V power.

DO NOT EXCEED THIS MAXIMUM NUMBER WHEN POWER LINKING UNITS!

All linked units must be of the same make and model type. Do not mix and match units!

MAINTENANCE GUIDELINES



DISCONNECT POWER BEFORE PERFORMING ANY MAINTENANCE!

CLEANING

Frequent cleaning is recommended to ensure proper function, optimized light output, and an extended life. The frequency of cleaning depends on the environment in which the fixture operates: damp, smoky, or particularly dirty environments can cause greater accumulation of dirt on the fixture's optics. Clean the external lens surface regularly with a soft cloth to avoid dirt/debris accumulation.

NEVER use alcohol, solvents, or ammonia-based cleaners.

MAINTENANCE

Regular inspections are recommended to ensure proper function and extended life. There are no user serviceable parts inside this fixture. Please refer all other service issues to an authorized ADJ service technician. Should you need any spare parts, please order genuine parts from your local ADJ dealer.

Please refer to the following points during routine inspections:

- A. A detailed electrical check by an approved electrical engineer every three months, to make sure the circuit contacts are in good condition and prevent overheating.
- B. Be sure all screws and fasteners are securely tightened at all times. Loose screws may fall out during normal operation, resulting in damage or injury as larger parts could fall.
- C. Check for any deformations on the housing, color lenses, rigging hardware, and rigging points (ceiling, suspension, trussing). Deformations in the housing could allow for dust to enter into the fixture. Damaged rigging points or unsecured rigging could cause the fixture to fall and seriously injure a person(s).
- D. Electric power supply cables must not show any damage, material fatigue, or sediments.

NEVER remove the ground prong from the power cable.

TORQUE SETTINGS FOR SCREWS

IN ORDER TO MAINTAIN THE IP65 RATING ON THE LIGHTING FIXTURES, ALL SCREWS MUST BE TIGHTENED TO THE FOLLOWING TORQUE SPECIFICATIONS USING A TORQUE DRIVER.

Refer to the table and diagram below for torque specifications.

TORQUE DRIVERS (Recommended): UTICA TS-30 (shown)

ALTERNATE DRIVERS:

- Proto J6107A
- Wiha 28887



CAUTION! DO NOT OVER TORQUE SCREWS, AS THIS CAN CAUSE LEAKAGE ISSUES!

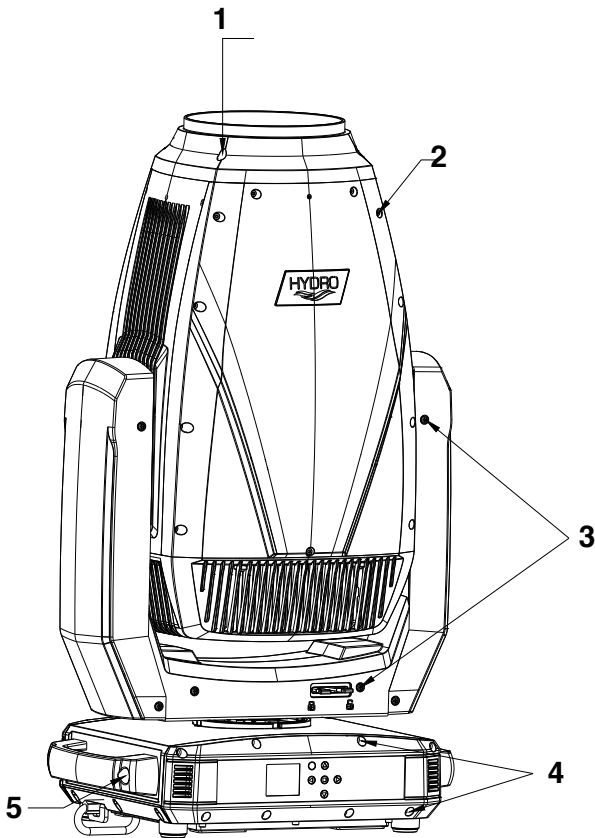

NO.	LOCATION	QUANTITY	TORQUE
1	Lens Cover	4	4.3 ± 0.4 Lb-in (5.0 ± 0.5 Kg-cm)
2	Head Cover x2	11 per cover	11.3 ± 0.4 Lb-in (13.0 ± 0.5 Kg-cm)
3	Arm Cover x2	8 per cover	4.3 ± 0.4 Lb-in (5.0 ± 0.5 Kg-cm)
4	Base Cover x2	8 per cover	11.3 ± 0.4 Lb-in (13.0 ± 0.5 Kg-cm)
5	Handle x2	2 per handle	11.3 ± 0.4 Lb-in (13.0 ± 0.5 Kg-cm)

IP TEST PARAMETERS

Following any repair or maintenance procedure that requires disassembly of the fixture, use ADJ's Hydro IP Tester to confirm the IP integrity of the fixture. The air valve is located on the back panel next to the display screen, as shown in the diagram below. Please contact ADJ Service for information regarding the ADJ Hydro IP Tester, or visit the product information page online at: <https://www.adj.com/hydro-ip-tester>

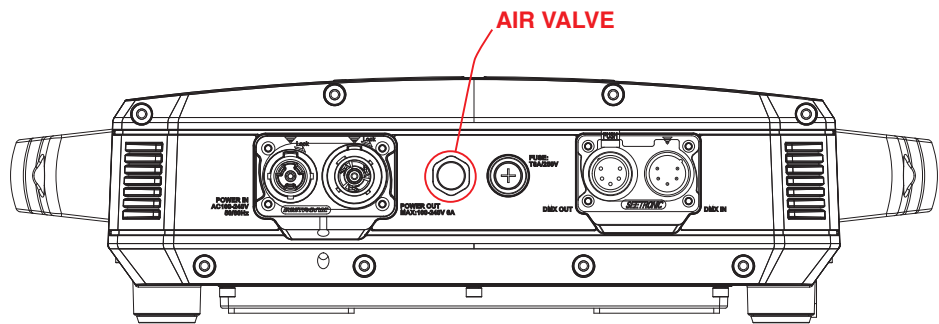

CAUTION! THE USE OF PROTECTIVE GLOVES AND SAFETY GOGGLES IS STRONGLY RECOMMENDED WHILE PERFORMING THE IP PRESSURE TEST! AVOID PLACING YOUR FACE, EYES, HANDS, ETC IN CLOSE PROXIMITY TO THE FIXTURE’S LENS WHILE PERFORMING THE TEST!

DE-HUMIDIFICATION: IP65 fixtures operating in high-humidity environments may experience residual fogging or condensation. Such fogging will not damage the fixture, and can be removed using the following procedure: position the unit with the air valve pointing upwards, then open the air valve and run the unit for 1-2 hours after reaching operating temperature. Then, while the fixture is still hot, re-install the air valve and allow the unit to cool down. Please note that this procedure should be performed in a dry, air-conditioned environment. Avoid additional fogging by drying the fixture completely before placing into a road case.



IP PRESSURE TESTING PARAMETERS					
Low Pressure Limit	High Pressure Limit	Inflation Time	Equilibrium Time	Detection Time	Acceptable Leakage
2.901 psi (20.0 KPa)	3.336 psi (23.0 KPa)	15 sec	15 sec	15 sec	0.015 psi (0.1 KPa) (100 Pa)

ERROR CODES

Code	Description
BaseTemp	Base temperature error
HeadTemp	Head temperature error
BalTemp	Ballast temperature error
BaseFan1	Base fan 1 error
BaseFan2	Base fan 2 error
BaseFan3	Base fan 3 error
BaseFan4	Base fan 4 error
LampFan1	Lamp fan 1 error
LampFan2	Lamp fan 2 error
GoboFan	Gobo fan error
CMYFan	CMY fan error
CoolFan1	Cooling fan 1 error
CoolFan2	Cooling fan 2 error
CoolFan3	Cooling fan 3 error
CoolFan4	Cooling fan 4 error
CoolFan5	Cooling fan 5 error
HeadFan1	Head fan 1 error
HeadFan2	Head fan 2 error
MotorFan	Motor fan error
Pan	Pan motor error
Tilt	Tilt motor error
Cyan	Cyan flag error
Magenta	Magenta flag error
Yellow	Yellow flag error
ColorWheel	Color wheel error
RotGobo	Rotating gobo wheel error
FixedGobo	Fixed gobo wheel error
Animation	Animation wheel error
Zoom	Zoom motor error
Focus	Focus motor error
Prism1	Prism 1 error
Prism1Rot	Prism 1 rotation error
Prism2	Prism 2 error
Prism2Rot	Prism 2 rotation error

DIMENSIONAL DRAWINGS

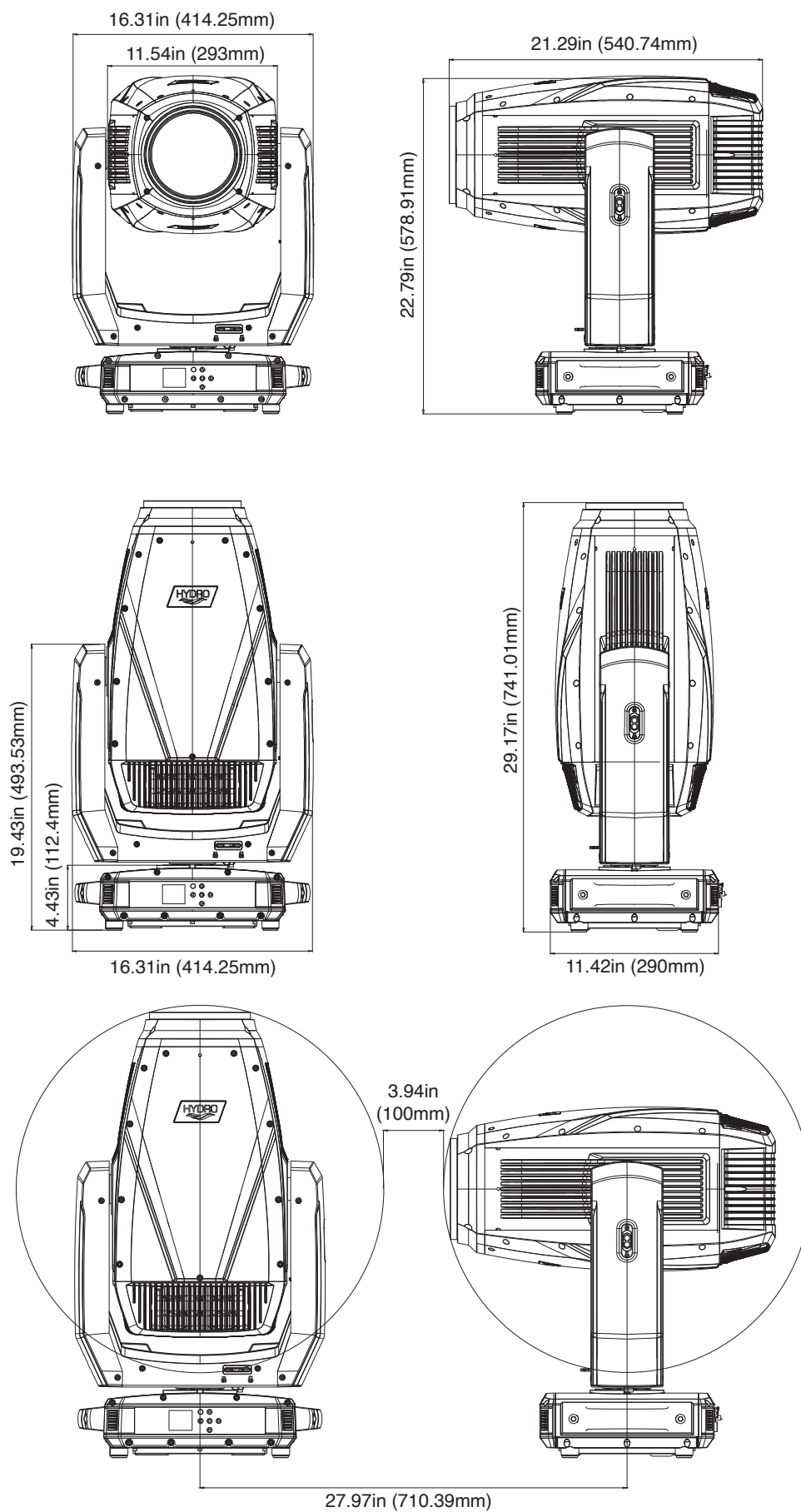

SPECIFICATIONS

SOURCE:

- Osram SIRIUS HRI 420W Discharge Lamp
- Full Power (420W)
- Up to 2,500 Hour Lamp Life

**Test lab conditions. May vary depending on several factors including but not limited to: Environmental Conditions, Power/Voltage, Usage Patterns (On-Off Cycling), Control, and Dimming.

PHOTOMETRIC DATA:

- Lumens: Beam Mode: 12,319, Spot Mode: 14,416
- Lux: Beam Mode: 562,600, Spot Mode: 223,200 (@5m, zoomed out)
- CRI: 77 +/- 5
- Correlate color temperature: 6500K +/- 300K
- Zoom Range: Beam Mode: 1.6°-17.7° / Spot Mode: 3.1°-39.2°

EFFECTS

- Beam, Spot and Wash
- Motorized Zoom
- Frost Filter (Heavy)
- Animation Wheel
- 2 Prisms on Dual Planes, 8-facet circular / 6-facet linear
- CMY/Color Macros
- Gobo/Prism Macros
- Motorized Focus
- High Speed Shutter and Strobe
- Pan Degree: 540°/630°
- Tilt Degree: 270°

COLOR:

- Full CMY Color Mixing System
- White Color Temp Presets
- 12 Position Color Wheel (Including: UV + CTO: 2700K, 3200K, 4000K)
- 27 Color Macros (Color Wheel + CMY)

GOBOS:

- 2 Gobo Wheels
- GOBO Wheel 1: 9 Interchangeable-Rotating / Indexing Glass Black & White Gobos
- GOBO Wheel 2: 14 Static-Stamped Metal Gobos (Including 4 beam reducers)

CONTROL / PHYSICAL:

- DMX and RDM Protocols
- 3 DMX Channel Modes (24, 27 & 32)
- 1 User Assignable DMX Channel Mode
- Aria X2 Wireless Management / DMX System
- (4) Button Touch Panel
- Full Color 180° Reversible LCD Menu Display
- Outdoor, IP66 5pin DMX In/Out Outdoor, IP66 Locking Power In/Out
- Pan/Tilt Locks

SIZE / WEIGHT:

- Length: 11.4" (290mm)
- Width: 16.31" (414.27mm)
- Height: 29.17" (741mm)
- Weight: 69.7 lbs. (31.6 kg)

ELECTRICAL / THERMAL:

- AC 100-240V 50/60Hz
- 580W Max Power Consumption
- -4° to 113°F (-20°C to 45°C)
- Min/Max Ambient Temperature: -20°C ~ 45°C

APPROVALS / RATINGS:

- CE, cETLus (Pending), IP65

FCC STATEMENT

This device complies with Part 15 of the FCC Rules. Operation is subject to the following two conditions: (1) this device may not cause harmful interference, and (2) this device must accept any interference received, including interference that may cause undesired operation.

FCC RADIO FREQUENCY INTERFERENCE WARNINGS & INSTRUCTIONS

This product has been tested and found to comply with the limits as per Part 15 of the FCC Rules. These limits are designed to provide reasonable protection against harmful interference in a residential installation. This device uses and can radiate radio frequency energy and, if not installed and used in accordance with the included instructions, may cause harmful interference to radio communications. However, there is no guarantee that interference will not occur in a particular installation. If this device does cause harmful interference to radio or television reception, which can be determined by turning the device off and on, the user is encouraged to try to correct the interference by one or more of the following methods:

- Reorient or relocate the device.
- Increase the separation between the device and the receiver.
- Connect the device and the radio receiver to electrical outlets on two different electrical circuits.
- Consult the dealer or an experienced radio/TV technician for help.

Energy Saving Matters (EuP 2009/125/EC)

Saving electric energy is a key to help protecting the environment. Please turn off all electrical products when they are not in use. To avoid power consumption in idle mode, disconnect all electrical equipment from power when not in use. Thank you!



